

Per tutti i puntali e copritesta interni alettati il \varnothing della testa si riferisce al \varnothing esterno del tubo, mentre per i non alettati il \varnothing del gambo si riferisce al \varnothing interno del tubo.

The diameter of the head for all ribbed inserts and cover caps is referred to the outside diameter of the tube. The diameter of the head for all non-ribbed inserts and cover caps is referred to the inside diameter of the tube.

IRA Puntali alettati in PE
Ribbed inserts for round tubes in PE

Codice Code	\varnothing testa \varnothing head	A	B	Bianco White	Nero Black
11-01-101-02(*)	10	13	5		
11-01-102-02(*)	12	10	5		
11-01-103-02	14	14	5		
11-01-104-02	16	16	5		
11-01-105-02	18	13	5		
11-01-106-02	20	13	5		
11-01-107-02	22	13	5		
11-01-108-02(*)	24	20	5		
11-01-109-02	25	19	5		
11-01-110-02(*)	26	20	5		
11-01-111-02	28	19	5		
11-01-112-02	30	19	5		
11-01-113-02	32	19	5		
11-01-114-02(*)	35	20	5		
11-01-115-02(*)	38	22	5		
11-01-116-02	40	22	5		
11-01-118-02	45	30	5		
11-01-280-02	48	22	7		
11-01-119-02	50	22	5		
11-01-120-02	60	24	5		
11-01-281-02	70	33	6		
11-01-122-02	80	33	5		
11-01-137-02	120	37	5		

Misure riferite al \varnothing esterno del tubo.
Per i pesi leggeri, per i \varnothing 50 - 60 - 80 si possono usare i copritesta CCR
Sizes referred to \varnothing external tube.
For light weight \varnothing 50 - 60 - 80 you can use article CCR

Pezzi per confezione **Lotto minimo**

Pieces per box/bag	Minimum quantity
5000	5000(*)
5000	5000(*)
5000	5000
5000	5000
5000	5000
8000	8000
7000	7000
4000	4000(*)
4000	4000
3500	3500(*)
3000	3000
2000	2000
2500	2500
2000	2000(*)
1500	1500(*)
1250	1250
1000	1000
1000	1000
800	800
500	500
250	250
200	200
75	150

(*) Colore bianco solo su richiesta, lotto minimo 10.000 pezzi

(*) White colour only on request, minimum order 10.000 pcs

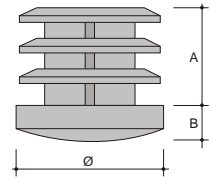

IRA1 Puntale a una aletta in PE
One rib insert in PE

Codice Code	\varnothing testa \varnothing head	A	B	Bianco White	Nero Black
11-01-265-02	25	6	6		

Misure riferite al \varnothing esterno del tubo.
Sizes referred to \varnothing external tube.

Pezzi per confezione **Lotto minimo**

Pieces per box/bag	Minimum quantity
5000	5000

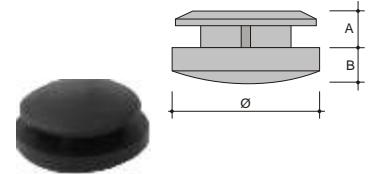

IRA2 Puntale a due alette in PE
Two ribs insert in PE

Codice Code	\varnothing testa \varnothing head	A	B	Bianco White	Nero Black
11-01-266-02	25	9	6		

Misure riferite al \varnothing esterno del tubo.
Sizes referred to \varnothing external tube.

Pezzi per confezione **Lotto minimo**

Pieces per box/bag	Minimum quantity
5000	5000

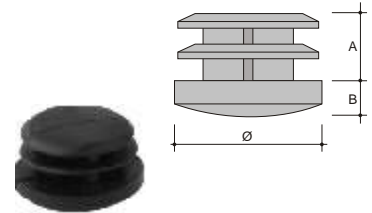

IRAP Puntali alettati in PE a base alta
Ribbed inserts in PE high head

Codice Code	\varnothing testa \varnothing head	A	B	Bianco White	Nero Black
11-01-131-02(*)	15	17	9		
11-01-132-02(*)	16	17	9		
11-01-133-02(*)	18	17	9		
11-01-135-02(*)	25	20	11		

Misure riferite al \varnothing esterno del tubo.
Sizes referred to \varnothing external tube.

Pezzi per confezione **Lotto minimo**

Pieces per box/bag	Minimum quantity
3000	3000(*)
3000	3000(*)
3000	3000(*)
2000	2000(*)

(*) Colore bianco, solo su richiesta, lotto minimo 10.000 pezzi

(*) White colour only on request, minimum order 10.000 pcs

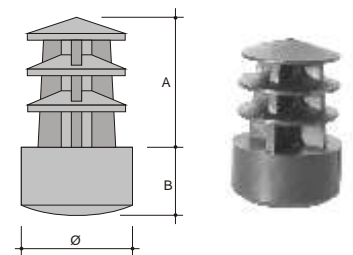

IRAFS Puntale filettato senza testa per tubo \varnothing 20
Threaded insert without head for tube \varnothing 20

Codice Code	\varnothing	A	B	Prezzo Price
11-01-260-02	18	25	M6	
11-01-260-02	18	25	M8	

Pezzi per confezione **Lotto minimo**

Pieces per box/bag	Minimum quantity
5000	10.000
5000	10.000

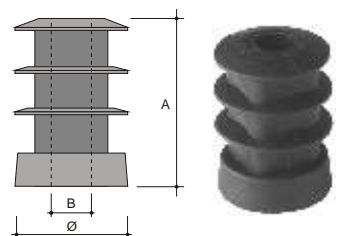

IRAF

Puntali rotondi alettati e filettati in PP Threaded round inserts in PP

Codice Code	Ø testa Ø head	A	B	Prezzo Price
11-01-140-02	18	18	6	
11-01-141-02	20	18	6	
11-01-142-02	22	19	6	
11-01-143-02	25	19	6	
11-01-144-02	28	19	6	
11-01-152-02(*)	28x2	19	6	
11-01-145-02	30	19	6	
11-01-146-02	32	19	6	
11-01-147-02	35	20	6	
11-01-148-02	40	20	6	
11-01-150-02	45	23	6	
11-01-149-02	50	21	6	
11-01-157-02(**)	60	25	7	
11-01-151-02	80	31	8	

Filetto M8 - M10

Misure riferite al Ø esterno del tubo - Da non usare per le rotelle.

Thread M8 - M10

Sizes referred to external Ø - Not to use with castors

Pezzi per confezione

Pieces per box/bag

Lotto minimo

Minimum quantity

2000	2000
2000	2000
1000	1000
2000	2000
1000	1000
1000	10000(*)
1000	1000
1000	1000
1000	1000
1000	1000
1000	1000
500	500
500	500
250	250(**)
200	200

(*) 28x2 solo su richiesta

(**) 60 filetto M8 solo su richiesta con lotto minimo 2.000 pezzi

(*) 28x2 only on request

(**) 60 M8 only on request and with a minimum order of 2.000 pcs

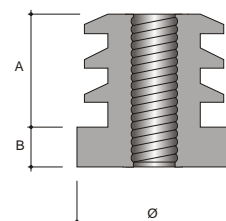

IRG

Puntali per ghiera Round insert with large base

Codice Code	Ø gambo x testa Ø for head leg	A	B	C	Bianco White	Nero Black
11-01-191-01(+)	8 x 18	16	3	5		
11-01-192-02(*)	°7-8 X 18	13	3	5		
11-01-193-01(*)	10 X 20	17	3	5		
11-01-194-01(*)	12 X 24	17	4	5		
11-01-195-01(*)	14 X 28	17	4	5		
11-01-196-02(*)	°15-16 X 26	16	4	5		
11-01-197-01(**)	17 X 32	18	4	5		
11-01-198-01(***)	18 X 32	19	4	6		
11-01-199-02(**)	°19-20 X 34	21	4	5		
11-01-201-02(**)	°22-23 X 36	29	4	6		

Le misure indicate con (°) sono alettate e in PE. Quelle lisce sono in PVC

Sizes indicated (°) are ribbed and in Pe. The smooth ones are in PVC

Pezzi per confezione

Pieces per box/bag

Lotto minimo

Minimum quantity

4000	4000(+)
2000	2000(*)
2000	2000(*)
1000	1000(*)
1000	1000(*)
1000	1000(*)
1000	1000(**)
1000	1000(*)
1000	5000(***)
1000	1000(**)
1000	1000(**)

(+) Colore bianco solo su richiesta, lotto minimo 12.000 pezzi

(*) Colore bianco solo su richiesta, lotto minimo 10.000 pezzi

(**) Colore bianco solo su richiesta, lotto minimo 5.000 pezzi

(***) Solo su richiesta

(+) White colour only on request, minimum order 12.000 pcs

(*) White colour only on request, minimum order 10.000 pcs

(**) White colour only on request, minimum order 5.000 pcs

(***) Only on request

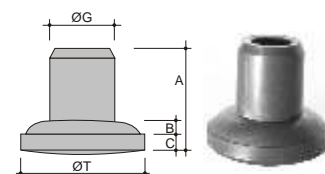
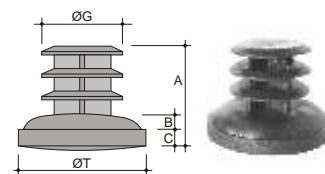

IRGI

Puntale per ghiera inclinato 12° in PE Round insert with large base in PE inclined 12°

Codice Code	Misura Measure	A	B	C	Bianco White	Nero Black
11-01-228-02(*)	22-23 x 36	19	1,5	7,5		

Pezzi per confezione

Pieces per box/bag

Lotto minimo

Minimum quantity

1000	5000(*)
------	---------

(*) Solo su richiesta

(*) Only on request

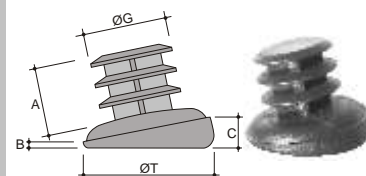

IRG

Ghiere per puntali
Metal ring for round inserts

Codice Code	Misura Ø Measure Ø	A	B	Ottonato Brass plated	Cromato Crome plated
11-01-211-68(*)	7-8	18	3		
11-01-212-68(*)	10	20	3		
11-01-213-68(**)	12	24	4		
11-01-214-68(+)	14	28	4		
11-01-215-68(***)	16	26	4		
11-01-216-68(+)	17-18	32	4		
11-01-217-68(***)	20	34	4		
11-01-218-68(***)	22	36	4		

Materiale: FE cromato
Material: FE chrome plated

Pezzi per confezione
Lotto minimo

Pieces per box/bag	Minimum quantity
4000	4000(*)
4000	4000(*)
2000	2000(**)
1000	10000(+)
1000	1000(***)
1000	5000(+)
1000	1000(***)
1000	1000(***)

(*) Ottonato solo su richiesta, lotto minimo 12.000 pezzi
(**) Ottonato solo su richiesta, lotto minimo 10.000 pezzi
(***) Ottonato solo su richiesta, lotto minimo 5.000 pezzi
(+) Solo su richiesta

(*) Brass only on request, minimum order 12.000 pcs

(**) Brass only on request, minimum order 10.000 pcs

(***) Brass only on request, minimum order 5.000 pcs

(+) Only on request

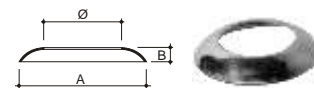

PTL

Puntale testa larga Ø40 per tubo spess. 1
Big head insert Ø40 with thickness 1 mm.

Codice Code	Ø	A	B	C	D	Nero Black
11-01-183-02	40	38	49	20	6	

Pezzi per confezione
Lotto minimo

Pieces per box/bag	Minimum quantity
1250	1250

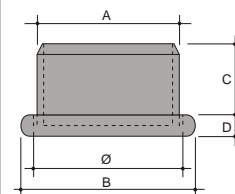

ITR

Innesto per tubi rotondi in PS
Tube connectors in PS

Codice Code	Ø A	B	C	S.T.	Prezzo Price
11-24-209-76	35	29	8MA	1	
21-24-210-00	40	32	8MA	1	
11-24-211-76	50	34	8MA	1	

Pezzi per confezione
Lotto minimo

Pieces per box/bag	Minimum quantity
500	500
100	400
600	600

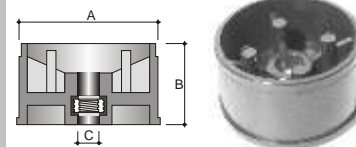

ITR

Innesto per tubi rotondi filettato in PA
Threaded connector for round tube in PA

Codice Code	Ø A	B	C	D	S.T.	Prezzo Price
11-24-208-05	30	4	19,5	8MA	1,2	

Pezzi per confezione
Lotto minimo

Pieces per box/bag	Minimum quantity
1000	1000

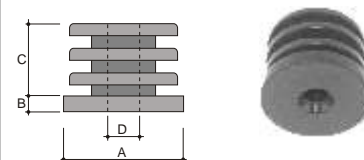

IRN

Puntali o sottopiedi in PVC

Ribbed inserts in PVC

Codice Code	Ø gambo Ø stem	A	B	C	Bianco White	Nero Black
11-01-231-01(*)	8	14	5	12		
11-01-232-01(*)	9	15	5	13		
11-01-233-01(*)	10	14	5	14		
11-01-234-01(*)	11	16	6	15		
11-01-235-01(*)	12	16	6	16		
11-01-236-01(*)	13	16	7	17		
11-01-237-01(*)	14	18	7	19		
11-01-238-01(*)	15	18	7	20		
11-01-239-01(*)	16	19	8	21		
11-01-240-01(*)	17	19	8	22		
11-01-241-01(*)	18	19	8	23		
11-01-242-01(*)	19	19	6	24		
11-01-243-01(*)	20	20	7	25		
11-01-244-01(*)	21	21	7	25		
11-01-245-01(*)	22	20	7	26		
11-01-246-01(*)	23	20	7	28		
11-01-247-01(*)	24	20	7	29		
11-01-248-01(*)	25	20	7	29		
11-01-249-01(*)	26	20	8	31		
11-01-250-01(*)	27	20	8	31		
11-01-251-01(*)	28	22	9	34		
11-01-252-01(*)	29	22	8	34		
11-01-256-01(*)	40	25	10	45		

Misure riferite al Ø interno del tubo.
Sizes referred to Ø internal tube

Pezzi per confezione.
Pieces per box/bag

Lotto minimo
Minimum quantity

10000	10000
10000	10000
10000	10000
5000	10000
5000	10000
5000	10000
4000	10000
5000	10000
2000	10000
2500	10000
-	10000
-	10000
-	10000
-	10000
1000	10000
-	10000
2000	10000
-	5000
1000	5000
1000	5000
1000	5000
1000	5000

(*) Solo su richiesta
(* Only on request)

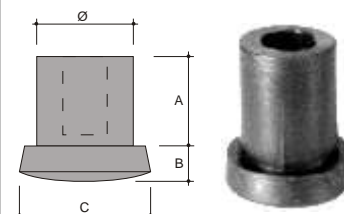

IRAI

Puntali alettati inclinati 30° in PE

Inclined ribbed inserts 30° in PE

Codice Code	Ø testa Ø head	A	B	Bianco White	Nero Black
11-01-161-02(*)	16	15	5		
11-01-162-02(*)	18	15	5		
11-01-164-02(*)	22	18	6		
11-01-165-02(*)	25	18	6		
11-01-166-02(*)	28	18	6		
11-01-170-02(*)	60	40	6		

Misure riferite al Ø esterno del tubo.
Sizes referred to Ø external tube

Pezzi per confezione.
Pieces per box/bag

Lotto minimo
Minimum quantity

5000	5000
5000	5000
5000	5000
2500	5000
2500	5000
500	1000

(*) Colore bianco solo su richiesta
(* White colour only on request)

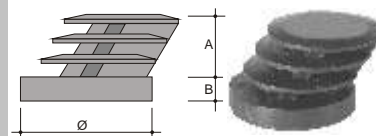

IRAI

Puntali alettati inclinati 13° in PE

Inclined ribbed inserts 13° in PE

Codice Code	Ø testa Ø head	A	B	C	Bianco White	Nero Black
21-01-171-00	25	18	5	10		

Misure riferite al Ø esterno del tubo.
Sizes referred to Ø external tube

Pezzi per confezione.
Pieces per box/bag

Lotto minimo
Minimum quantity

2000	4000
------	------

(*) Colore bianco solo su richiesta
(* White colour only on request)

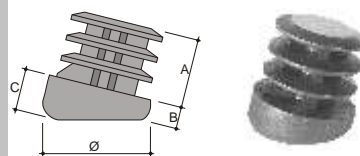

IRZI

Puntali con zoccolo inclinati 30° in PE

Inserts with inclined base 30° in PE

Codice Code	Ø testa Ø head	A	B	C	Bianco White	Nero Black
11-01-178-02(*)	18	21	16	5		
11-01-181-02(*)	25	25	23	6		

Misure riferite al Ø esterno del tubo
Sizes referred to Ø external tube

Pezzi per confezione.
Pieces per box/bag

Lotto minimo
Minimum quantity

5000	5000(*)
2000	2000(*)

(*) Colore bianco solo su richiesta,
lotto minimo 5.000 pezzi
(* White colour only on request,
minimum order 5.000 pcs)

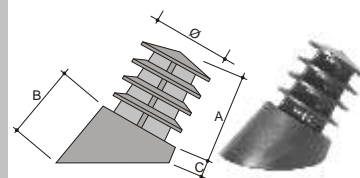

ITSA

Puntali copritesta, a testa sferica alettati in PE
Spherical round cover tube in PE

Codice Code	Ø testa Ø head	A	B	Bianco White	Nero Black
11-01-287-02(*)	16	12	7		
11-01-288-02	18	12	7,5		
11-01-289-02	20	15	9,0		
11-01-290-02	22	15	10,0		
11-01-291-02(*)	25	15	11,0		
11-01-292-02(*)	28	16	12,5		
11-01-293-02(*)	30	18	13,5		
11-01-294-02(*)	32	18	16,5		
11-01-295-02(*)	35	20	17,0		
11-01-297-02(*)	40	22	19,5		
11-01-299-02(*)	60	30	32		

Colorato solo a richiesta
Special colours only on request

A magazzino è disponibile ITSA Ø25 nel colore RAL 9006
Available in stock ITSA Ø25 RAL 9006

**Pezzi per
confez.**

**Pieces per
box/bag**

**Lotto
minimo**

**Minimum
quantity**

4000	4000(*)
4000	4000
4000	4000
4000	4000
4000	4000(*)
3000	3000(*)
2500	2500(*)
2000	2000(*)
1500	1500(*)
1000	1000(*)
250	250(*)

(*) Colore bianco solo su richiesta
Ø 16, 25 e 32 lotto minimo 4.000 pezzi
Ø 28 e 35 lotto minimo 6.000 pezzi
Ø 30, 40 e 60 lotto minimo 5.000 pezzi

(*) White colour only on request,
Ø 16, 25 e 32 minimum order 4.000 pcs
Ø 28 e 35 minimum order 6.000 pcs
Ø 30, 40 e 60 minimum order 5.000 pcs

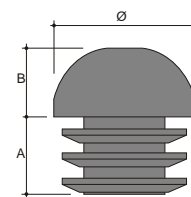

ITSA2

Puntali copritesta, a testa semisferica in PP
Spherical round cover tube in PP

Codice Code	Ø Testa Ø head	A	B	Bianco White	Nero Black
11-01-310-02(*)	20	15	7,5		
11-01-311-02(*)	22	17	8,5		
11-01-312-02(**)	25	18	10		
11-01-313-02(***)	30	20	10,5		

Colorato solo a richiesta
Special colours only on request

**Pezzi per
confez.**

**Pieces per
box/bag**

**Lotto
minimo**

**Minimum
quantity**

4000	4000(*)
4000	4000(*)
4000	4000(**)
2500	2500(***)

(*) Solo su richiesta
(**) Colore bianco solo su richiesta
(***) Colore bianco solo su richiesta
lotto minimo 5.000 pezzi

(*) Only on request
(**) White colour only on request
(***) White colour only on request,
minimum order 5.000 pcs

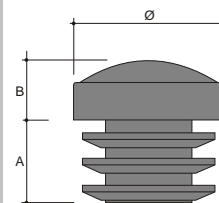

ITLA

Puntali copritesta, a testa liscia in PP
Cover tube with smooth head

Codice Code	Ø Testa Ø head	A	B	Bianco White	Nero Black
11-01-320-02(*)	20	15	7,5		
11-01-321-02(**)	22	17	8		
11-01-322-02(*)	25	18	9		
11-01-323-02(***)	30	20	10		

Colorato solo a richiesta
Special colours only on request

**Pezzi per
confez.**

**Pieces per
box/bag**

**Lotto
minimo**

**Minimum
quantity**

4000	4000(*)
4000	4000(**)
4000	4000(*)
2500	2500(***)

(*) Colore bianco solo su richiesta
(**) Solo su richiesta
(***) Colore bianco solo su richiesta,
lotto minimo 5.000 pezzi

(*) White colour only on request
(**) Only on request,
(***) White colour only on request,
minimum order 5.000 pcs

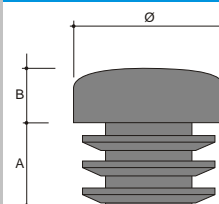

ITSC

Copritesta alettato in PE con testa sferica in FE cromato
Ribbed insert in PE with round metal head

Codice Code	Ø Testa Ø head	A	B	Ottonato Brass Plated	Cromato Chrome Plated
11-02-065-52(*)	25	15	12		

**Pezzi per
confez.**

**Pieces per
box/bag**

**Lotto
minimo**

**Minimum
quantity**

500	4000(*)
-----	---------

(*) Ottonato solo su richiesta,
lotto minimo 6.000 pezzi
(*) Brass only on request,
minimum order 6.000 pcs

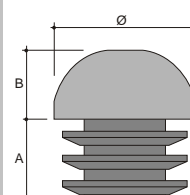

CCR**Copritesta alettato in PE**
Ribbed inserts in PE

Codice Code	Ø Testa Ø head	A	B	Bianco White	Nero Black
11-02-111-02	10	8	2		
11-02-112-02	12	8	2		
11-02-113-02	14	8	2		
11-02-114-02	15	8	3		
11-02-115-02	16	9,5	3		
11-02-116-02	18	9	3		
11-02-117-02	20	9,5	4		
11-02-106-02	22	10	4		
11-02-107-02	25	13	4		
11-02-108-02	28	15	5		
11-02-109-02	30	17	5		
11-02-090-02(*)	32	16	5		
11-02-091-02	35	17	5		
11-02-092-02	40	17	3		
11-02-093-02	45	17	5		
11-02-094-02	50	17	5		
11-02-095-02(**)	60	17	5		
11-02-097-02(***)	80	17	6		
11-02-085-02(****)	100	29	6		

Misure riferite all'esterno del tubo

Per i pesi leggeri, i Ø 50 - 60 -80-100 possono sostituire gli IRA

Sizes referred to external tube

The sizes Ø 50 - 60 -80-100 can be replaced by the article IRA for light weights

**Pezzi per
confez.****Lotto
minimo****Pieces per
box/bag****Minimum
quantity**

10000	10000
10000	10000
10000	10000
10000	10000
10000	10000
10000	10000
5000	5000
7500	7500
4000	4000
3000	3000
3000	3000
2500	2500(*)
2000	2000
1500	1500
1000	1000
1000	1000
750	750(**)
400	400(***)
100	100(****)

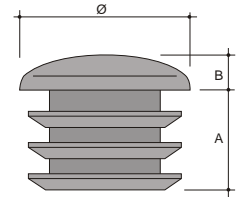

(*) Colore bianco solo su richiesta
lotto minimo 5.000 pezzi

(**) Colore bianco solo su richiesta
lotto minimo 1.500 pezzi

(***) Colore bianco solo su richiesta
lotto minimo 1.200 pezzi

(****) Colore bianco solo su richiesta
lotto minimo 1.000 pezzi

(*) White colour only on request,
minimum order 5.000 pcs

(**) White colour only on request,
minimum order 1.500 pcs

(***) White colour only on request,
minimum order 1.200 pcs

(****) White colour only on request,
minimum order 1.000 pcs

CCRC**Copritesta a 1 aletta in PE**
Ribbed insert in PE

Codice Code	Ø Testa Ø head	A	B	Bianco White	Nero Black
11-02-330-02	25	5	3,5		

**Pezzi per
confez.****Lotto
minimo****Pieces per
box/bag****Minimum
quantity**

5000	5000(*)
------	---------

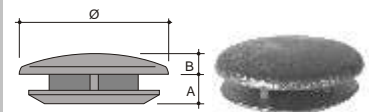

(*) Colore bianco solo su richiesta
lotto minimo 10.000 pezzi

(*) White colour only on request,
minimum order 10.000 pcs

CTM

Copritesta alettato in PE con testa in FE cromato
Ribbed insert in PE with metal head

Codice Code	Ø Testa Ø head	A	B	Ottonato Brass Plated	Cromato Chrome Plated
11-02-224-52(*)	13	8	2		
11-02-225-52(*)	14	10	2		
11-02-226-52(*)	16	10	2		
11-02-227-52(*)	18	10	2		
11-02-223-52(*)	19	10	2		
11-02-228-52(**)	20	10	3		
11-02-229-52(**)	22	11	3		
11-02-231-52(**)	25	15	3		
11-02-230-52(**)	25x1.5	15	3		
11-02-232-52(+)	25x1.8	15	3		
11-02-238-52(**)	25x2.0	15	3		
11-02-269-52(**)	25x4.5	15	3		
11-02-233-52(**)	28	15	3		
11-02-221-52(+)	28.6	15	3		
11-02-234-52(**)	30	16	3		
11-02-235-52(***)	32	16	3		
11-02-236-52(***)	35	16	3		
11-02-240-52(***)	38	16	3		
11-02-237-52(***)	40	16	3		
11-02-239-52(***)	45	16	3		

Misure riferite all'esterno del tubo
 Sizes Referred to external tube

**Pezzi per
confez.**

**Lotto
minimo**

Pieces per box/bag	Minimum quantity
1000	4000(*)
1000	2000(*)
1000	2000(*)
1000	2000(*)
1000	3000(*)
1000	3000(**)
1000	3000(**)
1000	3000(**)
1000	20000(+)
1000	3000(**)
1000	10000(+)
500	2000(**)
500	20000(+)
500	2000(**)
250	2000(***)
250	2000(***)
250	1000(***)
250	1000(***)
250	750(***)

(*) Ottone solo su richiesta
 lotto minimo 10.000 pezzi
 (**) Ottone solo su richiesta
 lotto minimo 5.000 pezzi
 (***) Ottone solo su richiesta
 lotto minimo 2.000 pezzi
 (+) Ottone/cromato solo su richiesta

(*) Brass only on request,
 minimum order 10.000 pcs
 (**) Brass only on request,
 minimum order 5.000 pcs
 (***) Brass only on request,
 minimum order 2.000 pcs
 (+) Brass/chrome only on request

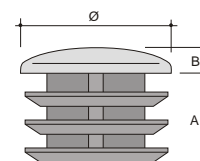

CRM

Copritesta in PP con testa in FE cromato
Ribbed insert in PE with metal top

Codice Code	Ø T. Ø T.	S.T. S.T.	A	B	Ottonato Brass Platted	Cromato Chrome Platted
11-02-245-52(*)	50	1.0	12	3		
11-02-246-52(*)	50	1.2	12	3		
11-02-247-52(*)	50	1.5	12	3		
11-02-248-52(*)	50	2.0	12	3		
11-02-249-52(*)	60	1.0	12	3		
11-02-250-52(*)	60	1.2	12	3		
11-02-251-52(*)	60	1.5	12	3		
11-02-252-52(*)	60	2.0	12	3		
11-02-258-52(**)	80	1.2	12	3		
11-02-259-52(*)	80	1.5	12	3		

CTM - CRM - Si possono fornire con foro Ø 6 per inserire la ventosa.

CTM - CRM can be supplied with hole Ø 6 for buffer

**Pezzi per
confez.**

**Lotto
minimo**

Pieces per box/bag	Minimum quantity
200	600(*)
200	600(*)
200	600(*)
200	600(*)
200	400(*)
200	400(*)
200	400(*)
200	400(*)
100	1000(**)
100	400(*)

(*) Ottone solo su richiesta
 lotto minimo 2.000 pezzi
 (**) Ottone/cromato solo su richiesta
 Ottone lotto minimo 2.000 pezzi

(*) Brass only on request,
 minimum order 2.000 pcs
 (**) Brass/chrome only on request,
 Brass minimum order 2.000 pcs

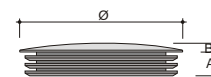

CS

Copritesta a sfera in PVC

Round ball in PVC

Codice Code	Ø Sfera Ø Ball	A	Ø B	Colorato/Bianco Coloured/White	Nero Black
11-02-161-01(*)	mm.10	7	3		
11-02-162-01(*)	mm.10	8	4		
11-02-163-01(*)	mm.14	12	5		

Adatte per terminali filo ferro

Suitable for wires

Pezzi per
confez.Lotto
minimoPieces per
box/bagMinimum
quantity

15000

15000(*)

15000

15000(*)

15000

15000(*)

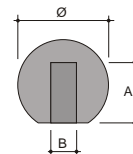
(*) Colorato e bianco solo su richiesta
lotto minimo 30.000 pezzi(*) Coloured and white only on request,
minimum order 30.000 pcs

CM

Copritesta tubi in FE imbutito

Round insert in metal

Codice Code	Ø Testa Ø head	S.T. S.T.	A	B	Prezzo Price
11-02-182-67	16	1.5	7	2	
11-02-183-67	18	1.5	7	2	
11-02-184-67(*)	18	1.2	7	2	
11-02-180-67(*)	18	1.0	7	2	
11-02-181-67	20	1.5	10	2	
11-02-185-67	20	1.2	10	2	
11-02-178-67	20	1.0	10	2	
11-02-179-67	22	1.5	9	3	
11-02-186-67	22	1.2	9	3	
11-02-167-67(*)	22,2	1,15	-	-	
11-02-188-67	25	1.2	9	3	
11-02-187-67	25	1.5	9	3	
11-02-189-67	28	1.5	7	3	
11-02-195-67	30	2.0	8	3	
11-02-190-67	30	1.5	8	3	
11-02-176-67(*)	30	0.85	8	3	
11-02-191-67	32	2.0	8	3	
11-02-192-67	32	1.5	8	3	
11-02-193-67(*)	32	1.2	8	3	
11-02-194-67(*)	32	1.0	8	3	
11-02-196-67	35	1.5	9	3	
11-02-197-67	35	1.2	9	3	
11-02-198-67	35	1.0	9	3	
11-02-199-67	40	1.0	9	4	
11-02-166-67	40	1.5	9	4	

Adatti per turare le estremità dei tubi.

Suitable to close tubes.

Pezzi per
confez.Lotto
minimoPieces per
box/bagMinimum
quantity

1000

1000

1000

1000

1000

5000(*)

1000

5000(*)

1000

1000

1000

1000

1000

1000

1000

1000

1000

1000

1000

5000(*)

1000

1000

1000

1000

1000

1000

1000

10000(*)

1000

1000

1000

1000

1000

1000

1000

5000(*)

1000

5000(*)

500

500

500

500

500

500

500

500

500

500

(*) Solo su richiesta

(*) Only on request

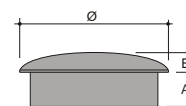

CGR

Copritesta rotondi in ABS neri cromati e metallizzati ottone
Round insert in ABS black chromed and brass plated

Codice Code	Ø T. Ø T.	S.T. S.T.	A	B	Nero	Cromato	Pezzi per box/bag	Lotto minimo
					Black	Metalizzato Chromed plated Brass metallized		
21-02-152-00	38	1.5	10	3			200	400
21-02-151-00	38	2	10	3			200	400
21-02-296-00	40	1	10	3			200	400
21-02-159-00	40	1.5	10	3			200	400
21-02-153-00	40	2	10	3			200	400
21-02-311-00	45	1.5	11	4			200	200
21-02-312-00	45	2	11	4			200	200
21-02-154-00	50	1	11	5			200	200
21-02-160-00	50	1.2	11	5			200	200
21-02-157-00	50	1.5	11	5			200	200
21-02-298-00	50	2	11	5			200	200
21-02-155-00	60	1	11	5			100	200
21-02-201-00	60	1.2	11	5			100	200
21-02-202-00	60	1.5	11	5			100	200
21-02-205-00	70	1.2	11	5			100	200
21-02-204-00	70	1.5	11	5			100	200
21-02-206-00	80	1.2	11	5			100	100
21-02-200-00	80	1.5	11	5			100	100
21-02-208-00	90	1.2	11	5			50	100
21-02-207-00	90	1.5	11	5			50	100
21-02-124-00	120	5	16	8			25	25

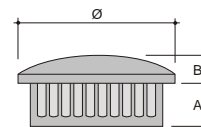

QIA

Puntali quadri alettati in PE
Square inserts in PE

Codice Code	Testa Head	A	B	Bianco White	Nero Black
11-03-121-02(*)	12 x 12	12	5		
11-03-122-02(**)	15 x 15	11	4		
11-03-123-02(**)	16 x 16	17	5		
11-03-124-02(**)	18 x 18	12	5		
11-03-125-02(****)	20 x 20	17	5		
11-03-126-02(****)	22 x 22	17	5		
11-03-127-02(****)	25 x 25	17	5		
11-03-128-02(****)	30 x 30	19	5		
11-03-135-02(+++)	32 x 32 (°)	21	6		
11-03-129-02(****)	35 x 35	18	6		
11-03-130-02(****)	40 x 40	18	6		
11-03-133-02(****)	45 x 45 (°)	21	5		
11-03-131-02(****)	50 x 50 (°)	21	6		
11-03-132-02(++)	60 x 60	24	6		
11-03-134-02(++)	70 x 70	25	6		
11-03-137-02(+)	80 x 80	30	6		
11-03-138-02(+)	100 x 100	30	6		

Misure riferite all'esterno del tubo

Sizes referred to external tube

Le misure indicate con (°) hanno la alettatura a croce

Models marked (°) have crossed ribs

Pezzi per confez.

Lotto minimo

Pieces per box/bag	Minimum quantity
3000	3000(*)
2500	2500(**)
2500	2500(**)
2500	2500(**)
5000	5000(****)
2000	2000(****)
2000	2000(****)
2000	2000(****)
1000	5000(+++)
1000	1000(****)
1000	1000(****)
500	500(****)
600	600(****)
450	450(++)
300	300(++)
100	100(+)
100	100(+)

(*) Colore bianco solo su richiesta, lotto minimo 12.000 pezzi
 (**) Colore bianco solo su richiesta, lotto minimo 10.000 pezzi
 (***) Colore bianco solo su richiesta, lotto minimo 6.000 pezzi
 (****) Colore bianco solo su richiesta, lotto minimo 5.000 pezzi
 (+) Colore bianco solo su richiesta, lotto minimo 1.000 pezzi
 (++) Colore bianco solo su richiesta, lotto minimo 900 pezzi
 (+++) Solo su richiesta

(*) White color only on request, minimum order 12.000 pcs
 (**) White color only on request, minimum order 10.000 pcs
 (***) White color only on request, minimum order 6.000 pcs
 (****) White color only on request, minimum order 5.000 pcs
 (+) White color only on request, minimum order 1.000 pcs
 (++) White color only on request, minimum order 900 pcs
 (+++) Only on request

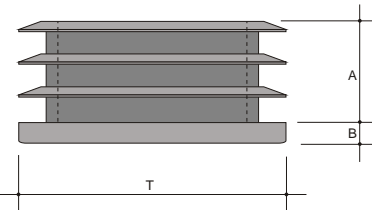
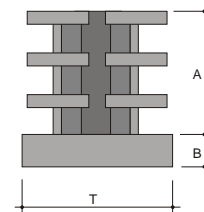

QIAS

Puntali quadri alettati in PE
Square inserts in PE

Codice Code	Testa Head	S.T.	A	B	Bianco White	Nero Black
11-03-270-02(*)	30 x 30	1	17	5,5		
11-03-271-02(**)	30 x 30	1	17	7,5		

Misure riferite all'esterno del tubo

Sizes referred to external tube

Pezzi per confez.

Lotto minimo

Pieces per box/bag	Minimum quantity
2000	2000(*)
2000	10000(**)

(*) Colore bianco solo su richiesta, lotto minimo 6.000 pezzi
 (**) Solo su richiesta

(*) White colour only on request, minimum order 6.000 pcs
 (**) Only on request

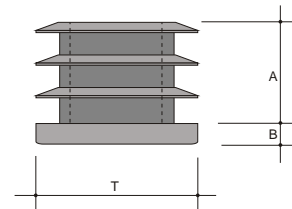

QAI

Puntali quadri alettati inclinati 30° in PE
Inclined square inserts 30°

Codice Code	Testa Head	A	B	Bianco White	Nero Black
11-03-166-02(*)	20 x 20	19	6		
11-03-167-02(*)	20 x 25	18	6		
11-03-168-02(*)	30 x 30	20	6		

Misure riferite all'esterno del tubo

Sizes referred to external tube

Pezzi per confez.

Lotto minimo

Pieces per box/bag	Minimum quantity
1000	1000(*)
1000	1000(*)
1000	1000(*)

(*) Colore bianco solo su richiesta, lotto minimo 10.000 pezzi

(*) White colour only on request, minimum order 10.000 pcs

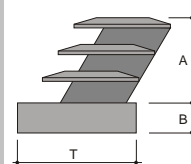
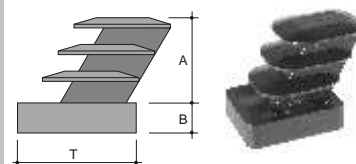

QI

Puntali quadri in PVC Square insert in PVC

Codice Code	Gambo Stem	A	B	Bianco White	Nero Black
11-03-101-01(*)	12 x 12	19	6		
11-03-102-01(*)	13 x 13	20	6		
11-03-103-01(*)	14 x 14	20	6		
11-03-104-01(*)	15 x 15	20	6		
11-03-105-01(*)	16 x 16	20	6		
11-03-106-01(*)	17 x 17	20	6		
11-03-107-01(*)	18 x 18	20	6		
11-03-108-01(*)	19 x 19	20	6		
11-03-109-01(*)	20 x 20	20	6		
11-03-110-01(*)	21 x 21	20	6		
11-03-111-01(*)	22 x 22	20	6		

Misure riferite all'interno del tubo
Sizes referred to internal tube

Pezzi per confezione Lotto minimo

Pieces per box/bag	Minimum quantity
-	10000(*)
-	10000(*)
-	10000(*)
-	10000(*)
-	5000(*)
1000	5000(*)
-	5000(*)
-	5000(*)
-	5000(*)
-	5000(*)
-	5000(*)

(*) Solo su richiesta

(*) Only on request

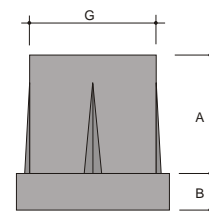

QIZ

Puntale quadro inclinato 10° alettato a zoccolo in PE Inclined ribbed square insert 10° in PE

Codice Code	Testa Head	A	B	C	Bianco White	Nero Black
11-03-170-02(*)	15 x 15	15	7	5		

Misure riferite all'esterno del tubo
Sizes referred to external tube

Pezzi per confezione Lotto minimo

Pieces per box/bag	Minimum quantity
5000	5000(*)

(*) Colore bianco solo su richiesta

(*) White colour only on request

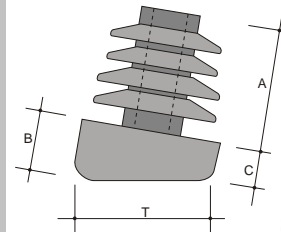

QAF

Puntali quadrati filettati e alettati in PP Threaded square ribbed insert in PP

Codice Code	Testa Head	A	B	Prezzo Price
11-03-151-02(*)	15 x 15	18	5	
11-03-152-02(**)	16 x 16	18	5	
11-03-153-02(**)	18 x 18	18	5	
11-03-154-02	20 x 20	18	5	
11-03-155-02(+)	22 x 22	18	5	
11-03-156-02	25 x 25	19	5	
11-03-157-02	30 x 30	20	6	
11-03-158-02	35 x 35	21	6	
11-03-159-02	40 x 40	22	6	
11-03-160-02	50 x 50	30	7	
11-03-163-02	60 x 60	25	7	
11-03-162-02(***)	80 x 80	30	8	

Filetto M8 - M10

Misure riferite all'esterno del tubo - Da non usare per le rotelle

Thread M8 - M10

Sizes referred to external tube - Not to use with castors

Pezzi per confezione Lotto minimo

Pieces per box/bag	Minimum quantity
1000	5000(*)
1000	5000(**)
1000	1000(**)
1000	1000
1000	5000(+)
1000	1000
1000	1000
500	500
500	500
250	250
250	250
250	250(***)

(*) 15x15 solo filetto M8

(**) 16x16, 18x18, Filetto M8; Filetto M10 a richiesta con lotto minimo 5.000 pezzi

(+) 22x22 solo su richiesta

(***) 80x80 filetto M10; a richiesta filetto M8 e M12, lotto minimo 1.000 pezzi

(*) 15x15 M8 only

(**) 16x16, 18x18, M8; M10 only on request and with a minimum order of 5.000 pcs

(+) 22x22 only on request

(***) 80x80 M10; M8 e M12 only on request and with a minimum order of 1.000 pcs

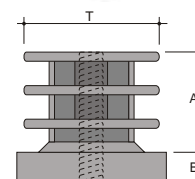

CQI
Copritesta quadri in PE
Square insert in PE

Codice Code	Testa Head	A	B	Bianco White	Nero Black
11-03-174-02(*)	12 x 12	9	3		
11-03-175-02(*)	14 x 14	10	3		
11-03-173-02(*)	15 x 15	11	3		
11-03-176-02(*)	16 x 16	10	3		
11-03-177-02(*)	18 x 18	10	3		
11-03-178-02	20 x 20	11	4		
11-03-179-02	25 x 25	15	5		
11-03-180-02	30 x 30	15	5		
11-03-181-02	35 x 35	15	4		
11-03-182-02	40 x 40	16	4		
11-03-183-02	50 x 50	20	5		
11-03-184-02	60 x 60	24	7		

Misure riferite all'esterno del tubo
 Sizes referred to external tube

Pezzi per confez.
Pieces per box/bag
Lotto minimo
Minimum quantity

Pezzi per confez. Pieces per box/bag	Lotto minimo Minimum quantity
5000	5000(*)
5000	5000(*)
5000	5000(*)
5000	5000(*)
5000	5000(*)
4000	4000
3000	3000
2000	2000
1500	1500
1500	1500
750	750
400	400

(*) Colore bianco solo su richiesta
 lotto minimo 10.000 pezzi

(*) White colour only on request,
 minimum order 10.000 pcs

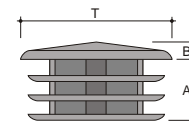
**ITSQ**
Puntale-Copritesta quadro con testa tonda
Square cover cap with round top

Codice Code	Testa Head	A	B	Bianco White	Nero Black
11-03-261-02(*)	15 x 15	15	8		
11-03-262-02(+)	18 x 18	16	8		
11-03-263-02(**)	20 x 20	19	9		
11-03-264-02(*)	22 x 22	18	11		
11-03-265-02(**)	25 x 25	19	12		

Pezzi per confez.
Pieces per box/bag
Lotto minimo
Minimum quantity

Pezzi per confez. Pieces per box/bag	Lotto minimo Minimum quantity
5000	5000(*)
5000	10000(+)
4000	4000(**)
2500	2500(*)
2000	2000(**)

(*) Colore bianco solo su richiesta
 lotto minimo 5.000 pezzi

(**) Colore bianco solo su richiesta
 lotto minimo 4.000 pezzi

(+) Solo su richiesta

(*) White colour only on request,
 minimum order 5.000 pcs

(**) White colour only on request,
 minimum order 4.000 pcs

(+) Only on request

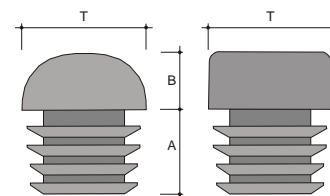
**CQM**
Copritesta in PE con testa in FE cromato
Square inserts in PE with metal top

Codice Code	Testa Head	A	B	Cromato Chrome plated	Ottonato Brass plated
11-03-243-52(*)	16 x 16	9	2		
11-03-244-52(*)	18 x 18	9	2		
11-03-245-52(*)	20 x 20	10	2		
11-03-246-52(**)	25 x 25	10	2		
11-03-247-52(**)	30 x 30	10	3		
11-03-248-52(**)	35 x 35	12	3		
11-03-249-52(**)	40 x 40	12	3		

Misure riferite all'esterno del tubo
 Sizes referred to external tube

Pezzi per confez.
Pieces per box/bag
Lotto minimo
Minimum quantity

Pezzi per confez. Pieces per box/bag	Lotto minimo Minimum quantity
1000	1000(*)
1000	1000(*)
1000	1000(*)
500	1000(**)
500	1000(**)
250	1000(**)
250	1000(**)

(*) Ottonato solo su richiesta
 lotto minimo 5.000 pezzi

(**) Ottonato solo su richiesta
 lotto minimo 2.000 pezzi

(*) Brass only on request,
 minimum order 5.000 pcs

(**) Brass only on request,
 minimum order 2.000 pcs

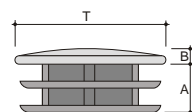

CGQ

Copritesta galvanizzati quadri in ABS
Square inserts in ABS

Codice Code	Testa Head	S.T. S.T.	A B		Nero Black	Cromato Metalizzato Chromed plated Brass metallized	Pezzi per confez. Pieces per box/bag	Lotto minimo Minimum quantity
			A	B				
21-03-196-00	12 x 12	1	7	2			1000	3000
21-03-197-00	12 x 12	1.2	7	2			1000	3000
21-03-198-00	15 x 15	1	8.5	2.5			1000	2000
21-03-202-00	15 x 15	1.2	8.5	2.5			1000	2000
21-03-205-00	15 x 15	1.5	8.5	2.5			1000	2000
21-03-207-00	16 x 16	1	8	3			1000	2000
21-03-199-00	16 x 16	1.5	8	3			1000	2000
21-03-191-00	18 x 18	1.2	8	3			500	2000
21-03-192-00	18 x 18	1.5	8	3			500	2000
21-03-212-00	20 x 20	1	7	3			500	1500
21-03-213-00	20 x 20	1.2	7	3			500	1500
21-03-193-00	20 x 20	1.5	7	3			500	1500
21-03-215-00	25 x 25	1	7	3			250	1000
21-03-216-00	25 x 25	1.2	7	3			250	1000
21-03-194-00	25 x 25	1.5	7	3			250	1000
21-03-217-00	25 x 25	2	7	3			250	1000
21-03-218-00	30 x 30	1	10	4			200	1000
21-03-219-00	30 x 30	1.2	10	4			200	1000
21-03-195-00	30 x 30	1.5	10	4			200	1000
21-03-222-00	35 x 35	1.2	11	4			200	600
21-03-200-00	35 x 35	1.5	11	4			200	600
21-03-225-00	40 x 40	1.2	11	4			100	200
21-03-201-00	40 x 40	1.5	11	4			100	200
21-03-189-00	45 x 45	1.2	11	5			100	100
21-03-190-00	45 x 45	1.5	11	5			100	100
21-03-228-00	50 x 50	1.2	11	5			100	100
21-03-229-00	50 x 50	1.5	11	5			100	100
21-03-232-00	60 x 60	1.2	12	5			100	100
21-03-233-00	60 x 60	1.5	12	5			100	100
21-03-236-00	80 x 80	1.2	12	5			50	200
21-03-237-00	80 x 80	1.5	12	5			50	200
21-03-238-00	80 x 80	2	12	5			50	200

Misure riferite all'esterno del tubo

Sizes referred to external tube

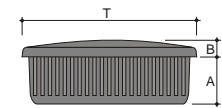

RIA

Puntali rettangolari alettati in PE
Rectangular ribbed insert in PE

Codice Code	Testa Head	A	B	Bianco White	Nero Black
11-04-100-02(*)	10 x 15	11	5		
11-04-101-02(*)	10 x 20	15	5		
11-04-102-02(**)	10 x 25	15	5		
11-04-103-02(**)	10 x 30	15	5		
11-04-098-02(°)	10 x 35	16.5	5		
11-04-099-02(**)	10 x 50	17	5		
11-04-115-02(**)	10 x 40	15	5		
11-04-104-02(**)	15 x 20	12	5		
11-04-105-02(**)	15 x 25	17	5		
11-04-106-02(**)	15 x 30	12	5		
11-04-107-02(*)	15 x 35	18	6		
11-04-108-02(**)	15 x 40	18	6		
11-04-123-02(**)	15 x 50	15	5		
11-04-283-02(**)	15 x 60	17	5		
11-04-121-02(***)	20 x 25	12	5		
11-04-109-02(****)	20 x 30	17	5		
11-04-110-02(****)	20 x 35	17	5		
11-04-111-02(****)	20 x 40	17	5		
11-04-112-02(****)	20 x 50	17	5		
11-04-113-02(****)	20 x 60	17	5		
11-04-282-02(+)	20 x 100	23	6		
11-04-114-02(****)	25 x 35	19	6		
11-04-118-02(****)	25 x 40	18	6		
11-04-116-02(****)	25 x 50	21	6		
11-04-124-02(°)	27 x 40	18	5		
11-04-120-02(*****)	30 x 40	18	6		
11-04-126-02(*****)	30 x 45	18	6		
11-04-117-02(*****)	30 x 50	18	6		
11-04-119-02(*****)	30 x 60	21	6		
11-04-280-02(+)	30 x 70	17	6		
11-04-281-02(+)	30 x 80	17	6		
11-04-127-02(+)	40 x 60	17	6		
11-04-284-02(++)	40 x 70	18	6		
11-04-122-02(+++)	40 x 80	23	6		
11-04-128-02(++++)	40 x 100	23	6		
11-04-129-02(+++)	50 x 100	23	6		

Misure riferite all'esterno del tubo
Sizes referred to external tube

Pezzi per confezione **Lotto minimo**

Pieces per box/bag	Minimum quantity
3000	3000(*)
3000	3000(*)
2500	2500(**)
2500	2500(**)
2000	10000(°)
2000	2000(**)
2000	2000(**)
2000	2000(**)
2000	2000(**)
5000	5000(**)
1500	1500(*)
1000	1000(**)
1000	1000(**)
1000	1000(**)
2000	2000(***)
2500	2500(****)
2500	2500(****)
2500	2500(****)
1000	1000(****)
1000	1000(****)
750	750(+)
1000	1000(****)
1000	1000(****)
1250	1250(****)
1000	10000(°)
1000	1000(*****)
1000	1000(*****)
1000	1000(*****)
1000	1000(*****)
750	750(+)
750	750(+)
750	750(+)
500	500(++)
450	450(+++)
400	400(++++)
300	300(+++)

(°) Solo su richiesta
(*) Colore bianco solo su richiesta lotto minimo 12.000 pezzi
(**) Colore bianco solo su richiesta lotto minimo 10.000 pezzi
(***) Colore bianco solo su richiesta lotto minimo 6.000 pezzi
(****) Colore bianco solo su richiesta lotto minimo 5.000 pezzi
(*****) Colore bianco solo su richiesta lotto minimo 3.000 pezzi
(+) Colore bianco solo su richiesta lotto minimo 1.500 pezzi
(++) Colore bianco solo su richiesta lotto minimo 1.000 pezzi
(+++) Colore bianco solo su richiesta lotto minimo 900 pezzi
(++++) Colore bianco solo su richiesta lotto minimo 800 pezzi

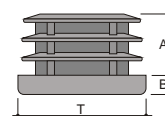

(°) Only on request
(*) White colour only on request minimum order 12.000 pcs
(**) White colour only on request minimum order 10.000 pcs
(***) White colour only on request minimum order 6.000 pcs
(****) White colour only on request minimum order 5.000 pcs
(*****) White colour only on request minimum order 3.000 pcs
(+) White colour only on request minimum order 1.500 pcs
(++) White colour only on request minimum order 1.000 pcs
(+++) White colour only on request minimum order 900 pcs
(++++) White colour only on request minimum order 800 pcs

CRI

Coprtesta/puntali rettangolari alettati in PE
Ribbed rectangular insert in PE

Codice Code	Testa Head	A	B	Bianco White	Nero Black
11-04-145-02(+)	20 x 80	16	3.0		
11-04-146-02(++)	25 x 100	15	3.0		
11-04-147-02(++)	30 x 100	16	3.0		

Misure riferite all'esterno del tubo
Sizes referred to external tube

Pezzi per confezione **Lotto minimo**

Pieces per box/bag	Minimum quantity
1000	1000(+)
600	600(++)
500	500(+++)

(+) Colore bianco solo su richiesta lotto minimo 5.000 pezzi
(++) Colore bianco solo su richiesta lotto minimo 3.000 pezzi
(+) White colour only on request, minimum order 5.000 pcs
(++) White colour only on request, minimum order 3.000 pcs

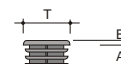

RAI

Puntali rettangolari alettati inclinati in PE Inclined ribbed rectangular insert in PE

Codice Code	Testa Head	A	B	Bianco White	Nero Black
Puntale rettangolare alettato inclinato 15° in PE Inclined ribbed rectangular insert 15° in PE					
11-04-184-02(*)	15 x 30	17	5		
Puntale rettangolare alettato inclinato 20° in PE Inclined ribbed rectangular insert 20° in PE					
11-04-183-02(*)	20 x 30	18	6		
Puntale rettangolare alettato inclinato 30° in PE Inclined ribbed rectangular insert 30° in PE					
11-04-181-02(**)	15 x 30	18	6		
11-04-182-02(*)	20 x 40	19	6		

Misure riferite all'esterno del tubo
Sizes referred to external tube

Pezzi per confez.

Pieces per
box/bag

Lotto minimo

Minimum
quantity

4000

4000(*)

2500

5000(*)

5000

5000(**)

1700

3400(*)

(*) Colore bianco solo su richiesta
(**) Solo su richiesta

(*) White colour only on request
(**) Only on request

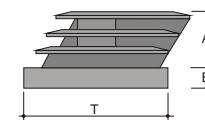

RIZ

Puntali rett. inclinato 30° alettati a zoccolo in PE Inclined ribbed rectangular insert 30° in PE

Codice Code	Testa Head	A	B	C	Bianco White	Nero Black
11-04-190-02(*)	15 x 30	22	22	5		

Misure riferite all'esterno del tubo
Sizes referred to external tube

Pezzi per confez.

Pieces per
box/bag

Lotto minimo

Minimum
quantity

2500

5000(*)

(*) Colore bianco solo su richiesta

(*) White colour only on request

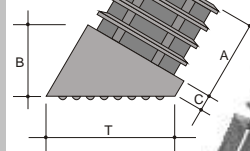
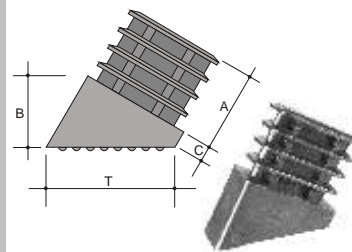

RIAS

Puntale rettangolare sagomato in PE Rectangular shaped insert in PE

Codice Code	Testa Head	A	B	Nero Black
11-04-270-02	30x 20	25	25	

Misure riferite all'esterno del tubo
Sizes referred to external tube

Pezzi per confez.

Pieces per
box/bag

Lotto minimo

Minimum
quantity

1000

1000

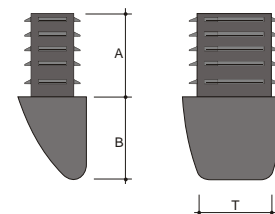

RAF

Puntali rettangolari alettati e filettati in PP
Threaded and ribbed insert in PP

Codice Code	Testa Head	A	B	Prezzo Price
11-04-165-02	20 x 30	19	6	
11-04-166-02(*)	20 x 35	19	6	
11-04-167-02	20 x 40	19	6	
11-04-168-02(**)	20 x 50	19	6	
11-04-169-02	20 x 60	19	6	
11-04-170-02	25 x 50	22	6	
11-04-171-02(*)	30 x 60	22	6	

Filetto M8 - M10

Misure riferite all'esterno del tubo - Da non usare per le rotelle

Thread M8 - M10

Sizes referred to external tube - Not to use with castors

Pezzi per confez.

Lotto minimo

Pieces per box/bag

Minimum quantity

1000	1000
1000	5000(*)
1000	1000
500	500(**)
500	500
500	500
500	3000(*)

(*) 20x35, 30x60 solo a richiesta
 (**) 20x50 filetto M8 solo a richiesta
 lotto minimo 5.000 pezzi

(*) 20x35, 30x60 only on request
 (**) 20x50 M8 only on request
 minimum order 5.000 pcs

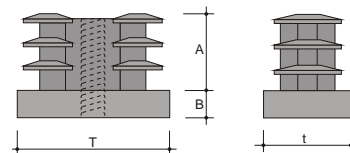

RAFI

Puntali rettangolari in PP con inserto filettato in ferro
Square inserts in PP with iron thread

Codice Code	Testa Head	A	B	C	Ø	Prezzo Price
11-04-250-73	25 x 50	22	6	M10	11	

Pezzi per confez.

Lotto minimo

Pieces per box/bag

Minimum quantity

500	500
-----	-----

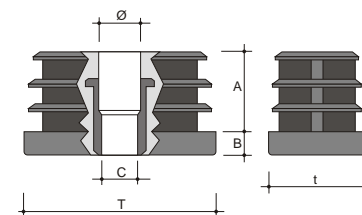

CRI Copritesta rettangolari alettati in PE Rectangular cover tube in PE					
Codice Code	Testa Head	A	B	Bianco White	Nero Black
11-04-130-02(*)	10 x 15	9	3.0		
11-04-131-02(*)	10 x 20	9	3.0		
11-04-144-02(**)	10 x 30.	9	3.0		
11-04-132-02(**)	10 x 40	10	3.0		
11-04-134-02(*)	15 x 20	10	3.5		
11-04-133-02(*)	15 x 25	10	3.5		
11-04-135-02(*)	15 x 30	10	3.5		
11-04-136-02(**)	15 x 35	10	3.5		
11-04-137-02(**)	15 x 40	10	3.5		
11-04-138-02	20 x 30	10	4.0		
11-04-139-02(*)	20 x 35	10	4.0		
11-04-140-02	20 x 40	11	4.0		
11-04-145-02(+)	20 x 80 (°)	16	3.0		
11-04-143-02(***)	25 x 40	12	4.0		
11-04-141-02(***)	25 x 50	12	4.0		
11-04-146-02(++)	25 x 100 (°)	15	3.0		
11-04-148-02(++)	30 x 40	13	5.0		
11-04-142-02(++)	30 x 50	13	5.0		
11-04-149-02(+++)	30 x 60	19	5.0		
11-04-147-02(++)	30 x 100 (°)	16	3.0		

Misure riferite all'esterno del tubo Sizes referred to external tube

Le misure indicate con (°) sono con testa piana e possono essere usate come puntali.
The items marked with (°) have flat head and can be used as inserts

(*) White colour only on request, minimum order 12.000 pcs
 (**) White colour only on request, minimum order 10.000 pcs
 (***) White colour only on request, minimum order 6.000 pcs
 (+) White colour only on request, minimum order 5.000 pcs
 (++) White colour only on request, minimum order 3.000 pcs
 (+++) White colour only on request, minimum order 2.400 pcs

Pezzi per confezione	Lotto minimo
Pieces per box/bag	Minimum quantity
4000	4000(*)
4000	4000(*)
2500	2500(**)
2500	2500(**)
3000	3000(*)
3000	3000(*)
3000	3000(*)
2500	2500(**)
2000	2000(**)
4000	4000
4000	4000(*)
2000	2000
1000	1000(+)
2000	2000(***)
1500	1500(***)
600	600(++)
1500	1500(++)
1000	1000(++)
1200	1200(+++)
500	500(++)

(*) Colore bianco solo su richiesta lotto minimo 12.000 pezzi
 (**) Colore bianco solo su richiesta lotto minimo 10.000 pezzi
 (***) Colore bianco solo su richiesta lotto minimo 6.000 pezzi
 (+) Colore bianco solo su richiesta lotto minimo 5.000 pezzi
 (++) Colore bianco solo su richiesta lotto minimo 3.000 pezzi
 (+++) Colore bianco solo su richiesta lotto minimo 2.400 pezzi

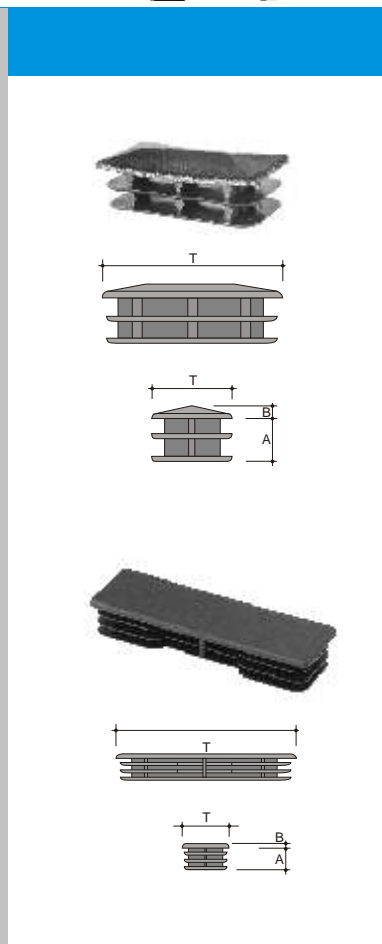

CRIS Copritesta destro e sinistro per stagge Cover tube left and right for levelling staves				
Codice Code	Testa Head	A	B	Nero Black
11-04-176-02 destro right	18x90	15	3	
11-04-177-02 sinistro left	18x90	15	3	

Pezzi per confezione	Lotto minimo
Pieces per box/bag	Minimum quantity
1000	1000
1000	1000

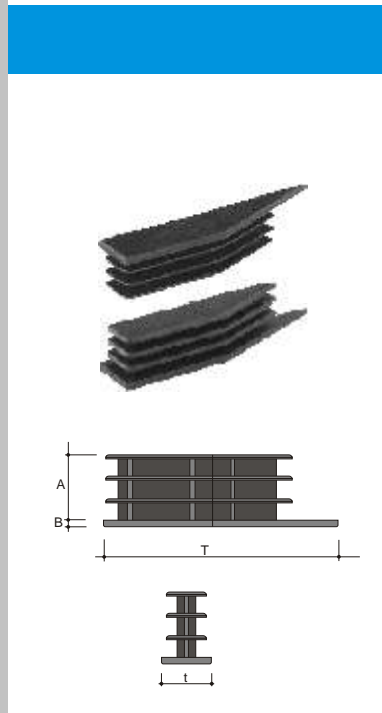

CRIE Copritesta in PP estetici rettangolari Rectangular cover tube in PP						
Codice Code	Testa Head	A	B	C	D	Nero Black
11-04-156-02	40 x 80	15	11	76	36	

Pezzi per confezione	Lotto minimo
Pieces per box/bag	Minimum quantity
500	500

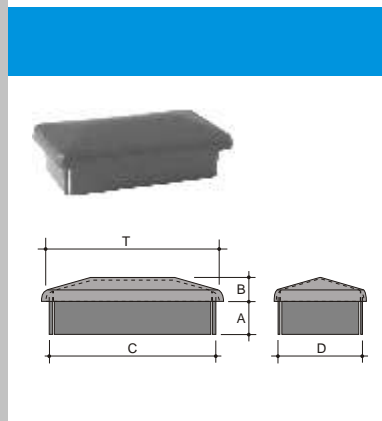

CRTM

Copritesta in PE rettangolare con testa in FE
Ribbed rectangular inserts in PE with metal top

Codice Code	Testa Head	A	B	Cromato Chrome plated	Ottonato Brass plated
11-04-260-52(*)	10 x 20	10	1.5		
11-04-261-52(*)	15 x 20	10	2.0		
11-04-263-52(*)	15 x 30	10	2.0		
11-04-262-52(*)	20 x 40	11	2.0		

**Pezzi per
confez.**

**Lotto
minimo**

Pieces per box/bag	Minimum quantity
1000	2000(*)
1000	1000(*)
1000	1000(*)
500	1000(*)

(*) Ottonato solo su richiesta
lotto minimo 5.000 pezzi

(*) Brass only on request,
minimum order 5.000 pcs

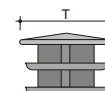
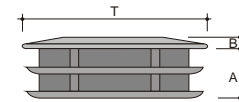

CRG

Copritesta rettangolari in ABS - nero - cromato metallizzato ottone
Rectangular insert in ABS - black - chrome brass plated

Codice Code	Testa Head	S.T.	A	B	Nero Black	Cromato Metalizzato Chromed plated Brass metallized
21-04-239-00	8 x 15	1,0	8	2,0		
21-04-202-00	10 x 15	1,0	9	1,0		
21-04-207-00	10 x 15	1,2	9	2,5		
21-04-216-00	10 x 20	1,0	9	2,5		
21-04-217-00	10 x 20	1,2	9	2,5		
21-04-221-00	10 x 25	1,5	9	2,5		
21-04-224-00	10 x 30	1,5	9	2,5		
21-04-208-00	10 x 40	1,2	9	3,0		
21-04-203-00	10 x 40	1,5	9	3,0		
21-04-200-00	15 x 20	1,2	9	3,0		
21-04-201-00	15 x 20	1,5	9	3,0		
21-04-229-00	15 x 25	1,5	9	3,0		
21-04-209-00	15 x 30	1,2	9	3,0		
21-04-204-00	15 x 30	1,5	9	3,0		
21-04-233-00	15 x 35	1,5	9	3,0		
21-04-234-00	15 x 40	1,0	9	3,0		
21-04-210-00	15 x 40	1,2	9	3,0		
21-04-205-00	15 x 40	1,5	9	3,0		
21-04-212-00	20 x 30	1,2	9	3,0		
21-04-211-00	20 x 30	1,5	9	3,0		
21-04-214-00	20 x 35	1,5	9	3,0		
21-04-213-00	20 x 40	1,2	9	3,5		
21-04-206-00	20 x 40	1,5	9	3,5		
21-04-244-00	20 x 40	2,0	9	3,5		
21-04-241-00	20 x 50	1,2	10	3,0		
21-04-242-00	20 x 50	1,5	10	3,0		
21-04-240-00	20 x 60	1,5	10	3,0		

**Pezzi per
confez.**

**Lotto
minimo**

Pieces per box/bag	Minimum quantity
1000	2000
1000	2000
1000	2000
1000	2000
1000	2000
1000	2000
500	2000
500	1000
500	1000
1000	1000
1000	1000
500	500
500	500
500	500
250	500
250	500
250	500
250	500
500	500
500	500
250	500
250	500
250	500
250	500
250	500
200	600
200	600
200	600

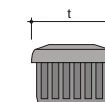
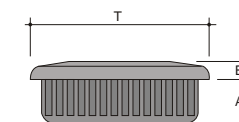

Misure riferite all'esterno del tubo

Sizes referred to external tube

EIA

Puntali a ellisse alettati in PE
Ribbed elliptical inserts in PE

Codice Code	Testa Head	A	B	Bianco White	Nero Black
11-05-101-02(*)	20 x 40	18	6		
21-05-100-00(*)	15 x 30	14	4		
11-05-099-02(**)	30 x 60	19	5		
11-05-098-02(*)	34 x 18	16	5		

Misure riferite all'esterno del tubo
Sizes referred to external tube

Pezzi per confezione **Lotto minimo**

Pieces per box/bag	Minimum quantity
2500	5000(*)
6000	6000(*)
1500	1500(**)
5000	5000(*)

(*) Colore bianco solo su richiesta
(**) Colore bianco solo su richiesta lotto minimo 3.000 pezzi

(*) White colour only on request
(**) White colour only on request, minimum order 3.000 pcs

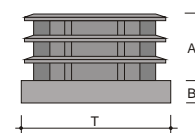

EIAS

Puntali a ellisse in PE
Ribbed inserts in PE

Codice Code	Testa Head	A	B	Nero Black
11-05-190-02	30 x 60	15	5	

Misure riferite all'esterno del tubo
Sizes referred to external tube

Pezzi per confezione **Lotto minimo**

Pieces per box/bag	Minimum quantity
1000	1000

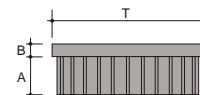

EIAI

Puntali a ellisse inclinati 10° in PE
Elliptical inclined ribbed insert 10° in PE

Codice Code	T	A	B	C	Bianco White	Nero Black
11-05-120-02(*)	15x30	12	2	7		

Pezzi per confezione **Lotto minimo**

Pieces per box/bag	Minimum quantity
6000	12000(*)

(*) Solo su richiesta
(*) Only on request

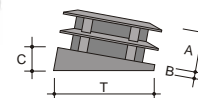

EIAD

Puntali a ellisse alettati in PE

Ribbed elliptical inserts in PE

Codice Code	Testa Head	A	B	Bianco White	Nero Black
21-05-102-00(*)	15 x 30	16	4		

Base c/ sporgenza da 1 lato per distanziare
Misure riferite all'esterno del tubo

Base whit one size spacer
Sizes referred to external tube

Pezzi per confezione

Pieces per box/bag

6000

Lotto minimo

Minimum quantity

6000(*)

(*) Colore bianco solo su richiesta

(*) White colour only on request

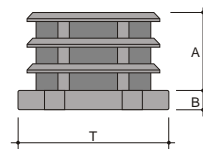

EIADI

Puntali a ellisse inclinati in PE

Elliptical inclined ribbed in PE

Codice Code	Testa Head	A	B	C	Bianco White	Nero Black
11-05-185-02	15 x 30	21	9	4		

Pezzi per confezione

Pieces per box/bag

3000

Lotto minimo

Minimum quantity

3000

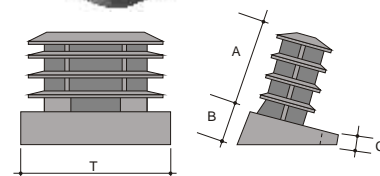

OIA

Puntali ovali alettati in PE

Ribbed oval inserts in PE

Codice Code	Testa Head	A	B	Bianco White	Nero Black
11-05-109-02(*)	12 x 25	12,5	5		
11-05-114-02(**)	15 x 30	17	5		
11-05-112-02(**)	18 x 36	18	6		
11-05-113-02(*)	20 x 40	19	6		
11-05-110-02(*)	25 x 50	17	5		
11-05-111-02(***)	30 x 60	18	5		

Misure riferite all'esterno del tubo
Sizes referred to external tube

(*) White colour only on request, minimum order 6.000 pcs

(**) White colour only on request, minimum order 5.000 pcs

(***) White colour only on request, minimum order 2.500 pcs

Pezzi per confezione

Pieces per box/bag

2000

5000

2500

2000

2000

1250

Lotto minimo

Minimum quantity

2000(*)

5000(**)

2500(**)

2000(*)

2000(*)

1250(***)

(*) Colore bianco solo su richiesta lotto minimo 6.000 pezzi

(**) Colore bianco solo su richiesta lotto minimo 5.000 pezzi

(***) Colore bianco solo su richiesta lotto minimo 2.500 pezzi

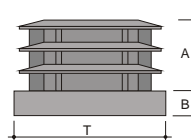

OIADI

Puntale alettato inclinato in PE

Inclined oval insert in PE

Codice Code	Testa Head	A	B	C	Bianco White	Nero Black
11-05-200-02	15 X 30	21	9	4		

Pezzi per confezione

Pieces per box/bag

3000

Lotto minimo

Minimum quantity

3000(*)

(*) Colore bianco solo su richiesta lotto minimo 6.000 pezzi

(*) White colour only on request, minimum order 6.000 pcs

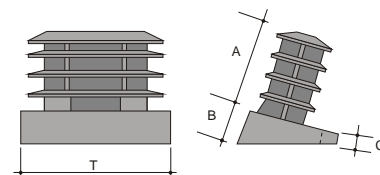

OIAS

Puntale ovale alettato in PE
Ribbed oval inserts in PE

Codice Code	A	B	C	D	E	Bianco White	Nero Black
11-05-116-02(*)	34	19,3	5	16,5	27,5		

Misure riferite all'esterno del tubo
Sizes referred to external tube

**Pezzi per
confez.** **Lotto
minimo**

**Pieces per
box/bag** **Minimum
quantity**

3500 3500 (*)

(*) Colore bianco solo su richiesta
lotto minimo 10.500 pezzi
(*) White colour only on request,
minimum order 10.500 pcs

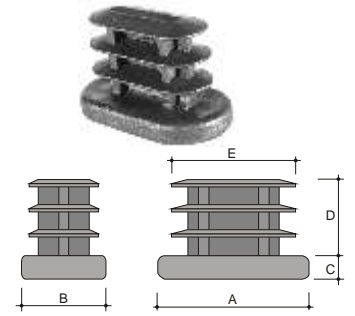

PIO

Puntali ovali inclinati 12,5° in PE
Inclined ribbed oval inserts 12,5 in PE

Codice Code	A	B	C	D	E	Bianco White	Nero Black
11-05-178-02(*)	30	15	13	7	11		

Misure riferite all'esterno del tubo
Sizes referred to external tube

**Pezzi per
confez.** **Lotto
minimo**

**Pieces per
box/bag** **Minimum
quantity**

1000 1000 (*)

(*) Colore bianco solo su richiesta
lotto minimo 5.000 pezzi
(*) White colour only on request,
minimum order 5.000 pcs

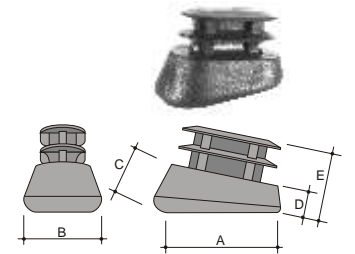

PIO

Puntali ovali inclinati alla base 20° e gambo 30° in PE
Ribbed oval inserts inclined bottom 20° leg 30° in PE

Codice Code	A	B	C	D	E	Bianco White	Nero Black
11-05-179-02(*)	30	15	9	4	11		

Misure riferite all'esterno del tubo
Sizes referred to external tube

**Pezzi per
confez.** **Lotto
minimo**

**Pieces per
box/bag** **Minimum
quantity**

2000 2000 (*)

(*) Colore bianco solo su richiesta
lotto minimo 6.000 pezzi
(*) White colour only on request,
minimum order 6.000 pcs

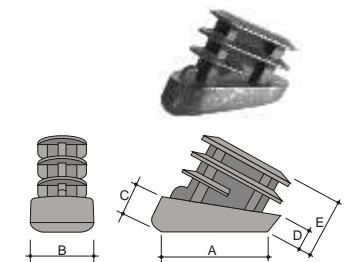

OAF

Puntali ovali alettati filettati in PP
Ribbed oval threaded inserts in PP

Codice Code	Testa Head	A	B	Prezzo Price
11-05-118-02(*)	18 x 36	18	6,5	
11-05-119-02(**)	20 X 40	18	6,5	

Filetto 10 MA
Misure riferite all'esterno del tubo - Da non usare per le rotelle

Threaded 10MA
Sizes referred to external tube - Not to use with castors

**Pezzi per
confez.** **Lotto
minimo**

**Pieces per
box/bag** **Minimum
quantity**

500 5000(*)
500 500(**)

(*) Solo su richiesta
(**) Filetto M8 solo su richiesta,
lotto minimo 5.000 pezzi
(*) Only on request
(**) Threaded M8 only on request,
minimum order 5.000 pcs

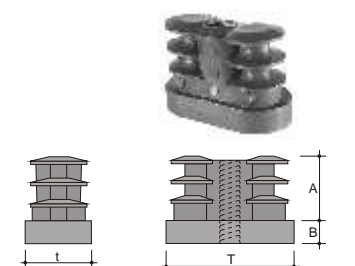

PCSO

Puntali copritesta semi ovali in PE

Ribbed half-oval inserts in PE

Codice Code	Testa Head	A	B	Bianco White	Nero Black
11-06-107-02(*)	15 x 30	12	3.0		
11-06-113-02(**)	20 X 40	13	3.5		
11-06-118-02(*)	25 X 40	13	3.5		

Misure riferite all'esterno del tubo
Sizes referred to external tube

(*) White colour only on request,
minimum order 10.000 pcs
(**) White colour only on request,
minimum order 10.500 pcs

Pezzi per confez.

Lotto minimo

Pieces per box/bag	Minimum quantity
2000	2000 (*)
1500	1500(**)
2000	2000(*)

(*) Colore bianco solo su richiesta
lotto minimo 10.000 pezzi
(**) Colore bianco solo su richiesta
lotto minimo 10.500 pezzi

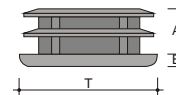

COM

Copritesta in PE ovale con testa in FE cromato

Ribbed oval inserts in PE with metal top

Codice Code	Testa Head	A	B	Cromato Chrome plated	Ottonato Brass plated
11-05-168-52(*)	10 x 20	10	2.0		
11-05-165-52(*)	15 X 30	10	2.5		
11-05-167-52(*)	18 X 36	11	3.0		
11-05-166-52(*)	20 X 40	10	3.0		

Misure riferite all'esterno del tubo
Sizes referred to external tube

Pezzi per confez.

Lotto minimo

Pieces per box/bag	Minimum quantity
1000	3000(*)
1000	3000(*)
500	2000(*)
500	2000(*)

(*) Ottonato solo su richiesta
lotto minimo 5.000 pezzi
(*) Brass only on request,
minimum order 5.000 pcs

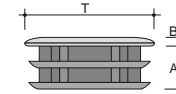

CEI

Copritesta a ellisse in PE

Ribbed elliptical inserts in PE

Codice Code	Testa Head	A	B	Bianco White	Nero Black
11-05-105-02(*)	15 x 30	10	3.0		
11-05-106-02(+)	18 x 36	10	3.5		
11-05-108-02(**)	20 x 35	11	5.0		
11-05-107-02(*)	20 x 40	11	4.0		

Misure riferite all'esterno del tubo
Sizes referred to external tube

Pezzi per confez.

Lotto minimo

Pieces per box/bag	Minimum quantity
2000	2000(*)
2000	6000(+)
2500	2500(**)
2000	2000(*)

(+) Solo su richiesta
(*) Colore bianco solo su richiesta,
lotto minimo 6.000 pezzi
(**) Colore bianco solo su richiesta,
lotto minimo 5.000 pezzi

(+) Only on request
(*) White colour only on request,
minimum order 6.000 pcs
(**) White colour only on request,
minimum order 5.000 pcs

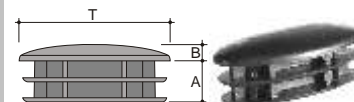

CEIS

Copritesta a ellisse in PE

Ribbed elliptical inserts in PE

Codice Code	Testa Head	A	B	Nero Black
21-05-195-00	30 x 60	15	10	

Misure riferite all'esterno del tubo
Sizes referred to external tube

Pezzi per confez.

Lotto minimo

Pieces per box/bag	Minimum quantity
-	-

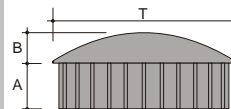

COC

Copritesta ovali in ABS - nero - cromato metallizzato ottone

Oval inserts in ABS black chrome brass plated

Codice Code	Testa Head	S.T. S.T.	A	B	Nero Black	Cromato Metalizzato Chromed plated Brass metallized
21-05-139-00	10 x 20	1.0	9	2.5		
21-05-140-00	10 x 20	1.2	9	2.5		
21-05-144-00	10 x 25	1.5	9	3.0		
21-05-147-00	15 x 25	1.5	9	3.0		
21-05-134-00	15 x 30	1.2	10	3.0		
21-05-132-00	15 x 30	1.5	10	3.0		
21-05-135-00	20 x 30	1.2	10	3.0		
21-05-133-00	20 x 30	1.5	10	3.0		
21-05-136-00	20 x 35	1.5	10	3.0		
21-05-159-00	20 x 40	1.5	10	3.0		
21-05-137-00	16 x 32	1.2	10	3.0		
21-05-138-00	17 x 45	1.5	10	3.0		

Misure riferite all'esterno del tubo
Sizes referred to external tube

Pezzi per confez.

Lotto minimo

Pieces per box/bag	Minimum quantity
1000	3000
1000	3000
1000	3000
500	3000
500	2000
500	2000
500	1000
500	1000
250	1000
250	1000
500	500
250	250

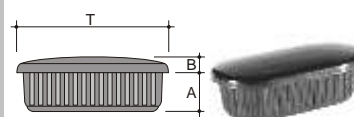

COI

Copritesta ovali alettati in PE

Ribbed oval inserts in PE

Codice Code	Testa Head	A	B	Bianco White	Nero Black
11-05-124-02(*)	10 x 20	10	2		
11-05-125-02(*)	15 x 30	10	3		
11-05-126-02(**)	18 x 36	10	3		
11-05-127-02(***)	20 x 40	10	4		
11-05-129-02(***)	25 x 50	17	5		
11-05-128-02(***)	30 x 60	22.5	3		

Misure riferite all'esterno del tubo
Sizes referred to external tube

(*) White colour only on request
(**) White colour only on request,
minimum order 5.000 pcs
(***) White colour only on request,
minimum order 6.000 pcs

Pezzi per confezione

Pieces per box/bag

Lotto minimo	Minimum quantity
5000	5000(*)
7500	7500(*)
2500	2500(**)
3000	3000(***)
2000	2000(***)
1500	1500(***)

(*) Colore bianco solo su richiesta
(**) Colore bianco solo su richiesta,
lotto minimo 5.000 pezzi
(***) Colore bianco solo su richiesta,
lotto minimo 6.000 pezzi

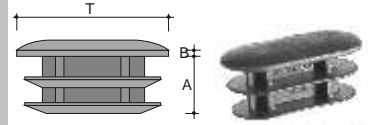

CPTA

Copritesta o puntali ovali testa alta in PE

Ribbed oval inserts large head in PE

Codice Code	A	B	C	D	Bianco White	Nero Black
11-05-171-02(*)	30	15	8	12		

Misure riferite all'esterno del tubo
Sizes referred to external tube

Pezzi per confezione

Pieces per box/bag

Lotto minimo	Minimum quantity
2000	2000(*)

(*) Colore bianco solo su richiesta
lotto minimo 6.000 pezzi

(*) White colour only on request,
minimum order 6.000 pcs

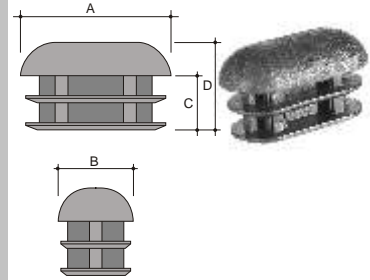

CPTA1

Copritesta ovali testa alta 1 aletta in PE

One rib oval insert in PE

Codice Code	A	B	C	D	Bianco White	Nero Black
11-05-174-02(*)	32	15	5	7,6		

Misure riferite all'esterno del tubo
Sizes referred to external tube

Pezzi per confezione

Pieces per box/bag

Lotto minimo	Minimum quantity
5000	5000(*)

(*) Solo su richiesta

(*) Only on request

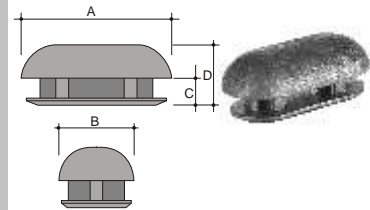

CONI

Copritesta ovale per tubo ovale

Oval cover cap for oval tube

Codice Code	A	B	C	D	Nero Black
11-05-180-02	32	15	28	36	

Misure riferite all'esterno del tubo
Sizes referred to external tube

Pezzi per confezione

Pieces per box/bag

Lotto minimo	Minimum quantity
40	400

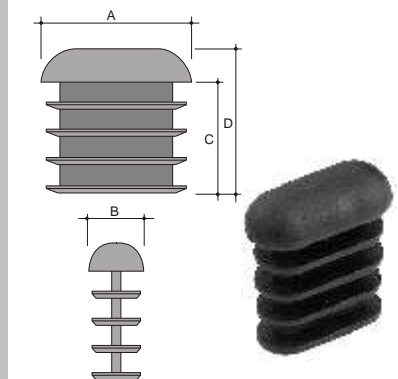

CENI

Copritesta ovale per tubo ellittico

Oval cover cap for elliptical tube

Codice Code	A	B	C	D	Nero Black
11-05-181-02	32	15	28	36	

Misure riferite all'esterno del tubo
Sizes referred to external tube

Pezzi per confezione

Pieces per box/bag

Lotto minimo	Minimum quantity
-	10000

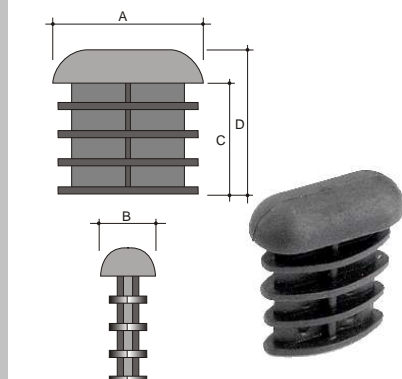

BPP

Base piana a pinza in PE per tondo 8
Clipse base for tube 8 mm.

Codice Code	Base Base	A	B	C	Neutro Neutral	Nero Black
11-06-122-02(*)	17 x 24	12.5	24	17		

Pezzi per confez. Lotto minimo

Pieces per box/bag Minimum quantity

5000 5000(*)

(*) Colore neutro solo su richiesta lotto minimo 20.000 pezzi

(*) Neutral colour only on request, minimum order 20.000 pcs

BPP

Base piana a pinza in PE per tondo 10
Clipse base for tube 10 mm.

Codice Code	Base Base	A	B	C	Neutro Neutral	Bianco White	Nero Black
11-06-120-02(*)	19 x 30	14.5	29.5	19			

Pezzi per confez. Lotto minimo

Pieces per box/bag Minimum quantity

5000 5000

(*) Colore bianco e neutro solo su richiesta lotto minimo 10.000 pezzi

(*) White and neutral colour only on request, minimum order 10.000 pcs

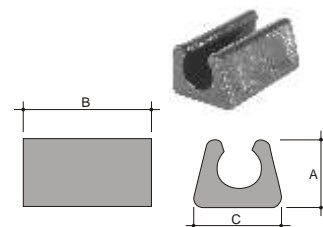

BPP

Base piana a pinza in PE per tondo 12
Clipse base for tube 12 mm.

Codice Code	Base Base	A	B	C	Neutro Neutral
11-06-123-02	22 x 31	16.5	31	22	

Pezzi per confez. Lotto minimo

Pieces per box/bag Minimum quantity

2500 2500

BPP

Base piana a pinza in PE per tondo 14
Clipse base for tube 14mm.

Codice Code	Base Base	A	B	C	Neutro Neutral	Nero Black
11-06-124-02(*)	24 x 33	18	33	24		

Pezzi per confez. Lotto minimo

Pieces per box/bag Minimum quantity

2500 10000(*)

(*) Solo su richiesta

(*) Only on request

BPPA

Base piana a pinza antirotazione in PE per tondo 11
Clipse base for tube 11 mm non-turning

Codice Code	Base Base	A	B	C	D	Neutro Neutral
11-06-130-02	17 x 24	14	30	17	20	

Pezzi per confez. Lotto minimo

Pieces per box/bag Minimum quantity

5000 5000

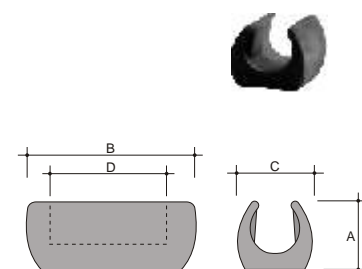

BPPD

Base piana a pinza doppia in PE per tondo 11
Double flat clip base for round tube 11 mm

Codice Code	Base Base	A	B	C	D	Neutro Neutral
11-06-135-02	35 x 31	16	31	35	15	

Pezzi per confez. Lotto minimo

Pieces per box/bag Minimum quantity

1500 1500

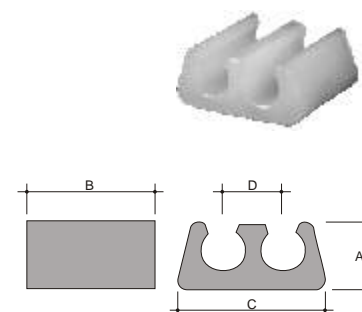

EX

Puntali export in PVC
Outer caps in PVC

Codice Code	Ø Tubo Ø Tube	A	B	Bianco White	Nero Black
11-10-124-01	2	7.5	6		
11-10-125-01(*)	3	9.5	8		
11-10-126-01	4	11	9		
11-10-127-01	5	13	10		
11-10-128-01	6	14	11		
11-10-130-01(**)	7	14	11		
11-10-129-01	8	16	13		
11-10-132-01	10	18	14		
11-10-133-01	12	21	17		
11-10-134-01(**)	13	21	17		
11-10-123-01	14	23	18		
11-10-135-01	16	25	20		
11-10-136-01	18	27	22		
11-10-138-01	20	30	24		
11-10-139-01	22	32	26		
11-10-147-01	25	32	29		
11-10-143-01	26	37	31		
11-10-141-01	28	38	32		
11-10-144-01	30	41	34		
11-10-142-01	32	43	39		
11-10-145-01	35	47	40		

Misure riferite al Ø esterno del tubo

Sizes referred to Ø external tube

**Pezzi per
confez.**

**Lotto
minimo**

Pieces per box/bag	Minimum quantity
6000	6000
5000	5000(*)
5000	5000
5000	5000
5000	5000
5000	5000(**)
5000	5000
5000	5000
3000	3000
2000	2000(**)
2000	2000
2000	2000
2000	2000
2000	2000
2000	2000
1500	1500
1000	1000
1000	1000
1000	1000
800	800
500	500

(*) Colore bianco solo su richiesta,
lotto minimo 30.000 pezzi

(**) Colore bianco solo su richiesta,
lotto minimo 10.000 pezzi

(*) White colour only on request,
minimum order 30.000 pcs

(**) White colour only on request,
minimum order 10.000 pcs

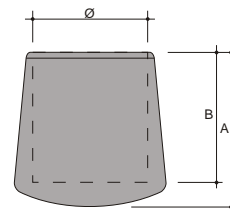

EX

Puntali export (misure speciali) in PVC
Outer caps (special sizes) in PVC

Codice Code	Ø Tubo Ø Tube	A	B	Bianco White	Nero Black
11-10-131-01(*)	9	17	13		
11-10-137-01(**)	19	28	23		
11-10-140-01	24-25	36	30		

Misure riferite al Ø esterno del tubo

Sizes referred to Ø external tube

**Pezzi per
confez.**

**Lotto
minimo**

Pieces per box/bag	Minimum quantity
2000	2000(*)
2000	2000(**)
1500	1500

(*) Colore bianco solo su richiesta,
lotto minimo 10.000 pezzi

(**) Colore bianco solo su richiesta,
lotto minimo 6.000 pezzi

(*) White colour only on request,
minimum order 10.000 pcs

(**) White colour only on request,
minimum order 6.000 pcs

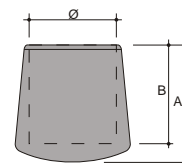

EC

Puntali a campana in PVC Outer caps in PVC

Codice Code	Ø Tubo Ø Tube	A	B	Bianco White	Nero Black
11-10-201-01(**)	6	20	16		
11-10-202-01(*)	8	23	18		
11-10-203-01(*)	10	25	21		
11-10-204-01(*)	12	27	23		
11-10-205-01(**)	14	28	22		
11-10-206-01(**)	16	29	22		
11-10-207-01(**)	18	31	24		
11-10-208-01(**)	20	33	26		
11-10-209-01(***)	22	35	27		
11-10-210-01(***)	24	35	28		
11-10-211-01(***)	26	37	32		
11-10-212-01(***)	28	41	34		
11-10-213-01(***)	30	44	36		

A base larga - Misure riferite al Ø esterno del tubo

Wide base - Size referred to external tube

Pezzi per confez.

Lotto minimo

Pieces per box/bag	Minimum quantity
2000	2000(**)
1500	1500(*)
1500	1500(*)
1500	1500(*)
1000	1000(**)
1000	1000(**)
1000	1000(**)
1000	1000(**)
1000	1000(***)
1000	1000(***)
500	500(***)
500	500(***)
500	500(***)

(*) Colore bianco solo su richiesta
lotto minimo 10.500 pezzi

(**) Colore bianco solo su richiesta
lotto minimo 10.000 pezzi

(***) Colore bianco solo su richiesta
lotto minimo 5.000 pezzi

(*) White colour only on request,
minimum order 10.500 pcs

(**) White colour only on request,
minimum order 10.000 pcs

(*) White colour only on request,
minimum order 5.000 pcs

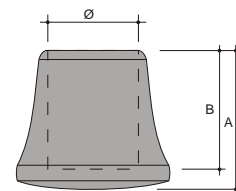

EL

Puntali bombati lunghi in PVC Outer caps in PVC

Codice Code	Ø Tubo Ø Tube	A	B	Bianco White	Nero Black
11-10-231-01(*)	10	28	22		
11-10-232-01(*)	12	31	24		
11-10-233-01(*)	14	34	27		
11-10-234-01(*)	16	36	29		
11-10-235-01(*)	18	38	31		
11-10-236-01(**)	20	40	33		

Misure riferite all'esterno del tubo

Sizes referred to external tube

Pezzi per confez.

Lotto minimo

Pieces per box/bag	Minimum quantity
4000	4000(*)
4000	4000(*)
2000	4000(*)
2000	2000(*)
2000	2000(*)
1500	1500(**)

(*) Colore bianco solo su richiesta
lotto minimo 4.000 pezzi

(**) Colore bianco solo su richiesta
lotto minimo 4.500 pezzi

(*) White colour only on request,
minimum order 4.000 pcs

(**) White colour only on request,
minimum order 4.500 pcs

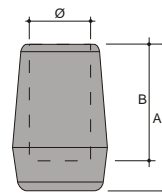

EB

Puntali a botte in PVC Outer caps in PVC

Codice Code	Ø Tubo Ø Tube	A	B	Bianco White	Nero Black
11-10-220-01(*)	6	19	14		
11-10-221-01(*)	8	21	16		
11-10-222-01(**)	10	23	18		
11-10-223-01(**)	12	26	20		
11-10-224-01(**)	14	28	21		
11-10-225-01(**)	16	30	23		
11-10-226-01(**)	18	31	24		

Misure riferite all'esterno del tubo

Sizes referred to external tube

Pezzi per confez.

Lotto minimo

Pieces per box/bag	Minimum quantity
4000	4000(*)
4000	4000(*)
5000	10000(**)
2500	10000(**)
2500	10000(**)
2500	10000(**)
2500	10000(**)

(*) Colore bianco solo su richiesta
lotto minimo 12.000 pezzi

(**) Colore bianco solo su richiesta
lotto minimo 10.000 pezzi

(*) White colour only on request,
minimum order 12.000 pcs

(**) White colour only on request,
minimum order 10.000 pcs

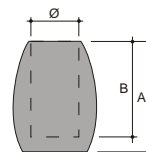

ETL
Puntale esterno leggero in PE
Small outer caps in PE

Codice Code	Ø Tubo Ø Tube	A	B	Bianco White	Nero Black
11-10-149-02(*)	15	24	20		
11-10-150-02(*)	16	20	14		
11-10-151-02(*)	18	23	17		
11-10-152-02(**)	20	25	19		
11-10-153-02(***)	22	22	18		
11-10-154-02(**)	24	23	17		
11-10-155-02(**)	25	23	17		
11-10-156-02(**)	26	25	19		
11-10-157-02(+)	28	26	20		
11-10-158-02(**)	30	27	21		

Misure riferite all'esterno del tubo
 Sizes referred to external tube

**Pezzi per
 confez.**
**Lotto
 minimo**

Pieces per box/bag	Minimum quantity
2000	2000(*)
2500	2500(*)
2500	2500(*)
2000	2000(**)
2500	2500(***)
2000	2000(**)
2000	2000(**)
2000	2000(**)
2000	2000(**)
2000	4000(+)
1500	1500(**)

(*) Colore bianco solo su richiesta
 lotto minimo 10.000 pezzi
 (**) Colore bianco solo su richiesta
 lotto minimo 6.000 pezzi
 (***) Colore bianco solo su richiesta
 lotto minimo 5.000 pezzi
 (+) Solo su richiesta

(*) White colour only on request,
 minimum order 10.000 pcs
 (**) White colour only on request,
 minimum order 6.000 pcs
 (***) White colour only on request,
 minimum order 5.000 pcs
 (+) Solo su richiesta

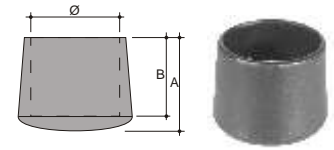
**PPL**
Puntali per piedi letto in PE
Insert for bed feet in PE

Codice Code	A	B	C	D	Nero Black
11-23-141-02	Ø50	Ø64	32	9,5	

**Pezzi per
 confez.**
**Lotto
 minimo**

Pieces per box/bag	Minimum quantity
350	350

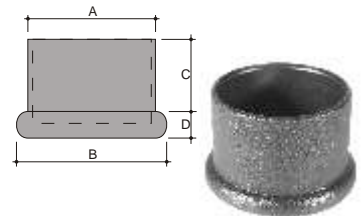
**ERI**
Puntali inclinati 20° in PVC
Round inserts inclined 20° in PVC

Codice Code	Ø Tubo Ø Tube	A	B	C	Bianco White	Nero Black
11-10-185-01(*)	25	38	27	20		

Misure riferite all'esterno del tubo
 Sizes referred to external tube

**Pezzi per
 confez.**
**Lotto
 minimo**

Pieces per box/bag	Minimum quantity
1500	1500(*)

(*) Colore bianco solo su richiesta
 lotto minimo 6.000 pezzi
 (*) White colour only on request,
 minimum order 6.000 pcs

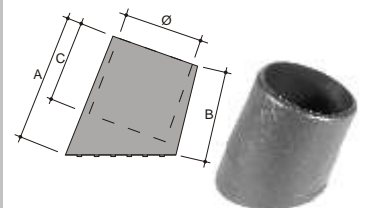

STY

Puntale esterno Style in PP
Outer caps in PP

Codice Code	A	B	C	D	Colorato Coloured	Nero Black
11-10-190-02(*)	20	35	23	20		

Misure riferite all'esterno del tubo
Sizes referred to external tube

Pezzi per confezione **Lotto minimo**

Pieces per box/bag **Minimum quantity**

400 2800(*)

(*) Solo su richiesta.
Colorato lotto minimo 5000 pezzi
(*) Only on request.
Coloured minimum order 5000 pcs

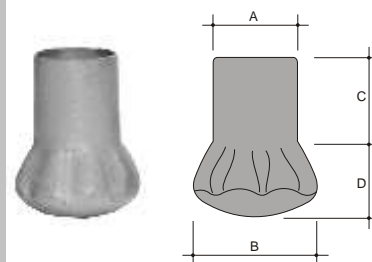

POB2

Puntale esterno ovale con base inclinata in PVC
Oval inserts with inclined base in PVC

Codice Code	A	B	C	D	Bianco White	Nero Black
11-11-170-01(*)	15	30	26	40		

Misure riferite all'esterno del tubo
Sizes referred to external tube

Pezzi per confezione **Lotto minimo**

Pieces per box/bag **Minimum quantity**

1000 1000 (*)

(*) Colore bianco solo su richiesta
lotto minimo 5.000 pezzi
(*) White colour only on request,
minimum order 5.000 pcs

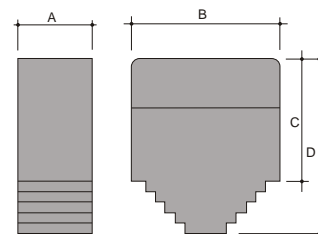

PEO

Puntale esterno ovale in PVC
Outer oval cap in PVC

Codice Code	A	B	C	Bianco White	Nero Black
11-11-174-01(*)	15	30	23		
11-11-175-01(*)	18	36	27		
11-11-176-01(*)	20	40	28		

Misure riferite all'esterno del tubo
Sizes referred to external tube

Pezzi per confezione **Lotto minimo**

Pieces per box/bag **Minimum quantity**

3000 3000(*)
1500 1500(*)
1500 1500(*)

(*) Colore bianco solo su richiesta
lotto minimo 9.000 pezzi
(*) White colour only on request,
minimum order 9.000 pcs

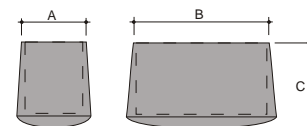

PEE

Puntale esterno a elisse in PVC Outer elliptical cap in PVC

Codice Code	A	B	C	Bianco White	Nero Black
11-11-120-01(*)	30	15	23		

Misure riferite all'esterno del tubo
Sizes referred to external tube

Pezzi per confez.

Pieces per
box/bag

3500

Lotto minimo

Minimum
quantity

3500(*)

(*) Colore bianco solo su richiesta
lotto minimo 10.500 pezzi
(*) White colour only on request,
minimum order 10.500 pcs

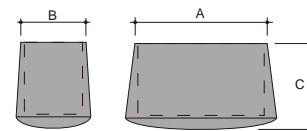

PSAR

Piedi scala artiglio in PVC Ladder feet in PVC

Codice Code	Ø Tubo Ø Tube	A	B	C	Nero Black
11-11-141-01	30	69	53	78 x 42	
11-11-142-01	32	72	59	82 x 45	
11-11-143-01	35	71	56	86 x 46	
11-11-144-01	38	83	67	92 x 52	
11-11-145-01	40	78	62	91 x 52	

Misure riferite all'esterno del tubo
Sizes referred to external tube

Pezzi per confez.

Pieces per
box/bag

200

200

150

150

100

Lotto minimo

Minimum
quantity

200

200

150

150

100

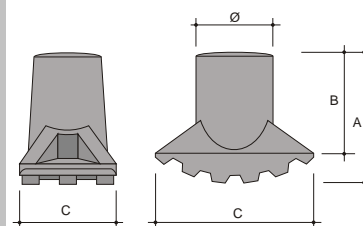

PSAO

Piedi scala artiglio ovale in PVC Ladder oval feet in PVC

Codice Code	Misura Size	A	B	C	Nero Black
11-11-161-01	20 x 40	70	57	90 x 37	
11-11-162-01	25 x 50	89	77	110 x 46	

Misure riferite all'esterno del tubo
Sizes referred to external tube

Pezzi per confez.

Pieces per
box/bag

200

100

Lotto minimo

Minimum
quantity

200

100

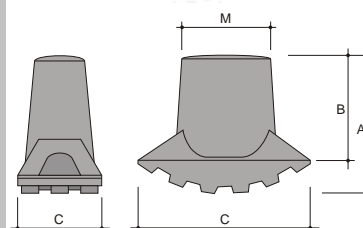

PSP
Piedi scala a pera in PVC
Ladder feet in PVC

Codice Code	Ø Tubo Ø Tube	A	B	C	Nero Black
11-11-151-01	20	35	29	31	
11-11-152-01	28	48	40	44	
11-11-153-01	30	47	38	42	
11-11-154-01	32	49	40	45	
11-11-155-01	35	53	42	48	
11-11-156-01	38	57	45	53	
11-11-157-01	40	59	47	56	

Misure riferite all'esterno del tubo

Sizes referred to external tube

**Pezzi per
confez.**
**Pieces per
box/bag**
**Lotto
minimo**
**Minimum
quantity**

1000	1000
500	500
400	400
400	400
300	300
300	300
200	200

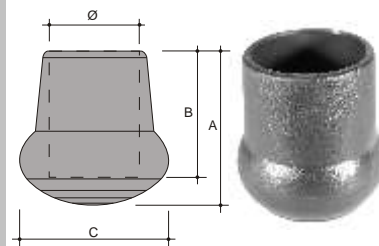
PSPO
Puntali scala a pera ovali in PVC
Ladder oval feet in PVC

Codice Code	Misura Size	A	B	C	Nero Black
11-11-165-01	20 x 40	40	34	52 x 32	
11-11-166-01	25 x 50	50	43	65 x 40	

Misure riferite all'esterno del tubo

Sizes referred to external tube

**Pezzi per
confez.**
**Pieces per
box/bag**
**Lotto
minimo**
**Minimum
quantity**

600	600
300	300

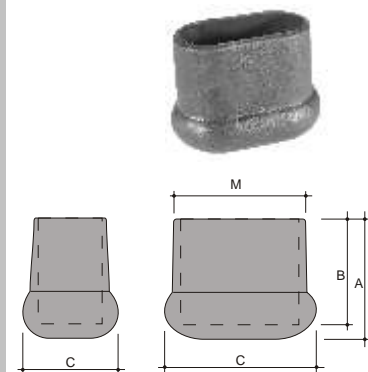

ASC

Puntali per angolari in PE
Angle bases in PE

Codice Code	Misura Size	A	B	Nero Black
11-12-104-02	27 x 27	11,5	9,5	

Spessore mm.1,5
Thickness mm.1,5

Pezzi per confezione **Lotto minimo**

Pieces per box/bag **Minimum quantity**

3500 3500

ASC

Puntali per angolari in PE
Angle bases in PE

Codice Code	Misura Size	A	B	Nero Black
11-12-100-02	30 x 30	12.5	10	
11-12-101-02	35 x 35	12.5	10	
11-12-102-02	40 x 40	13.0	10	

Spessore mm.3
Thickness mm.3

Pezzi per confezione **Lotto minimo**

Pieces per box/bag **Minimum quantity**

3000 3000
3000 3000
2250 2250

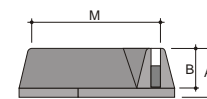

ASC

Puntali per angolari in PE
Angle bases in PE

Codice Code	Misura Size	A	B	Nero Black
11-12-103-02	32 x 32	12,5	10	

Spessore mm.3
Thickness mm.3

Pezzi per confezione **Lotto minimo**

Pieces per box/bag **Minimum quantity**

3000 3000

ADS

Puntali doppio angolare in PE
Double angle base in PE

Codice Code	Misura Size	A	B	Nero Black
11-12-105-02	70 x 35	12,5	10	

Spessore mm.2
Thickness mm.2

Pezzi per confezione **Lotto minimo**

Pieces per box/bag **Minimum quantity**

1000 5000

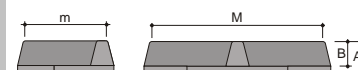

ASL

Puntali per angolari a L in PE
Angle bases L type in PE

Codice Code	Misura Size	A	B	Nero Black
11-12-110-02	35 x 55	12.5	9.5	
11-12-112-02	20 x 40	13.0	10.0	

Spessore mm.2
Thickness mm.2

Pezzi per confezione **Lotto minimo**

Pieces per box/bag **Minimum quantity**

1000 5000
5000 5000(*)

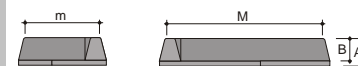

Codice Code	Misura Size	A	B	Nero Black
11-12-111-02	35 x 55	12.5	9.5	
11-12-113-02	20 x 40	13.0	10.0	

Pezzi per confezione **Lotto minimo**

Pieces per box/bag **Minimum quantity**

1000 5000
5000 5000(*)

Destri
Right

Sinistri
Left

(*) Solo su richiesta
(*) Only on request

AUS

Puntali angolari a U in PVC Angle bases U type in PVC

Codice Code	Misura Size	A	B	Nero Black
11-12-115-01	30 x 30 x 35	25	18	

Spessore mm.2
Thickness mm.2

Pezzi per confez.

Pieces per
box/bag

1000

Lotto minimo

Minimum
quantity

1000

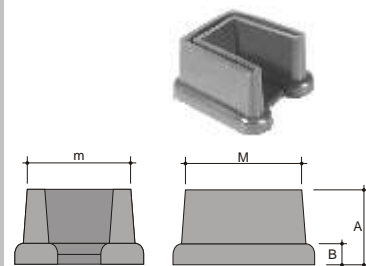

EA

Puntali angolari in PE Angles bases in PE

Codice Code	Misura Size	A	B	Nero Black
11-12-121-02	20 x 20	20	15	
11-12-122-02	25 x 25	24	19	
11-12-123-02	30 x 30	24	19	
11-12-124-02	35 x 35	24	19	

Adatti per essere infilati negli appoggi ad angolo
Used to be put in angle support

Pezzi per confez.

Pieces per
box/bag

2000

2000

1000

1000

Lotto minimo

Minimum
quantity

2000

2000

1000

1000

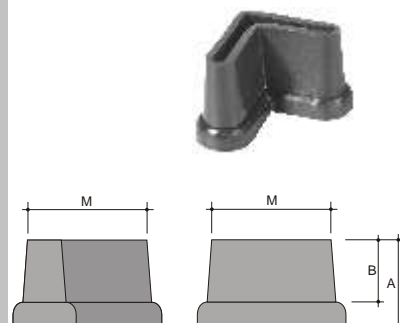

EAL

Puntali angolari base diritta in PE Angle bases in PE

Codice Code	Misura Size	A	B	Nero Black
11-12-129-02	25 x 25	25	20	

Misure riferite all'esterno del tubo
Sizes referred to external tube

Pezzi per confez.

Pieces per
box/bag

2000

Lotto minimo

Minimum
quantity

2000

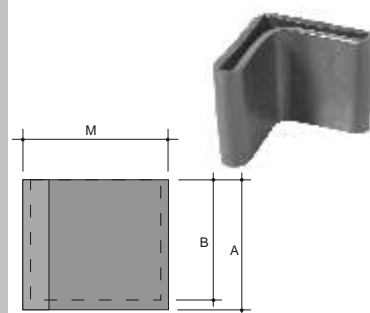

PEP

Puntale esterno per piatto in PVC Angle bases in PVC

Codice Code	Misura Size	A	B	Nero Black
11-12-135-01	25 x 8	19	15	
11-12-138-01	25 x 5	19	15	
11-12-136-01	25 x 6	19	15	
11-12-137-01	30 x 6	19	15	

Pezzi per confez.

Pieces per
box/bag

2500

2500

2500

2500

Lotto minimo

Minimum
quantity

5000

5000

5000

5000

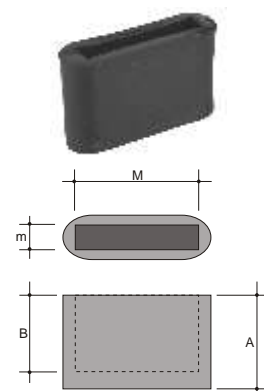

Tubo spessore mm.1,2

Tube Thickness mm. 1,2

ITQ

Innesti per tubo quadro 20x20 in ABS
Tube connector for tube 20x20 in ABS

Pezzi per confezione

Lotto minimo

Codice Code	A	B	C	Nero Black	Cromato Chrome plated	Metalizzato Brass plated	Pieces per box/bag	Minimum quantity	
21-12-201-00 MOD. 3 vie MOD. 3 ways	25	25	17,6				50	50	
21-12-202-00 MOD. 4 vie MOD. 4 ways	25	25	17,6				50	50	
21-12-203-00 MOD. 5 vie MOD. 5 ways	25	25	17,6				50	50	
21-12-204-00 MOD. 6 vie MOD. 6 ways	25	25	17,6				50	50	
21-12-205-00 MOD. a L MOD. a L	25	25	17,6				50	100	
21-12-206-00 MOD. a T MOD. a T	25	25	17,6				50	50	
21-12-207-00 MOD. a CROCE MOD. at CROSS	25	25	17,6				50	50	

Tubo spessore mm.1,2

Tube thickness mm.1,2

ITQ
Innesti per tubo quadro 25x25 in ABS
Tube connectors for tube 25x25 in ABS

Codice Code	A	B	C	Nero Black	Cromato Chrome plated	Metalizzato Brass plated	Pezzi per confezione	Lotto minimo	
							Pieces per box/bag	Minimum quantity	
21-12-211-00 MOD. 3 vie MOD. 3 ways	30	30	22,6				25	50	
21-12-212-00 MOD. 4 vie MOD. 4 ways	30	30	22,6				25	50	
21-12-213-00 MOD. 5 vie MOD. 5 ways	30	30	22,6				25	50	
21-12-215-00 MOD. a L MOD. a L	30	30	22,6				25	100	